

instituto de arte
MARU:

video 1.68 x 31.

pelicula 1.67 x 30.1

30

Degas

MA

3.03

30.3

lapi dado

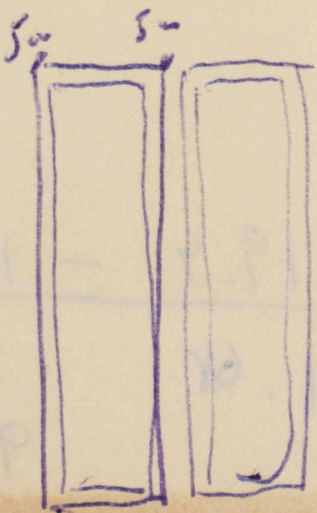

Contemporânea

$$\frac{19.4}{1.60} = \frac{4.5}{x}$$

$$x = 28.8$$

$$37.4$$

$$1.67$$

$$\frac{19.4}{1.60}$$

$$\frac{135.}{1.67} = 30.1$$

$$1.67 = 30.1$$

$$\frac{19.4}{1.68} = \frac{4.5}{x}$$

$$x = 38.4$$

$$\frac{19.4}{1.68} = 10.5$$

$$68$$

$$x$$

$$90.9$$

$$\frac{19.4}{1.68} = \frac{3.5}{x}$$

$$30.1$$

$$\frac{30.1}{1.68} = 30.3$$
$$\frac{30.3}{1.68} = 31.3$$

$$\frac{1.68}{1.69}$$

Amosado - (leaves made) - 2^o feixe.

Rare, OMPs.

pedido do idio: Jorie
Divinal 814, 29. 66.

custo 324,00

1.68 x 30 m. on.

lepidoto -

→ 6¹/₂.

el 99973224.

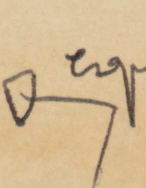
2^o andar -  equando.

$$\frac{29.5}{1.600} = \frac{19.7}{x} \quad x = 106 = \underline{35.6}$$

$$\frac{19.7}{100} = \frac{29.5}{x}$$

$$\begin{array}{r} 45 \times 320 \\ \hline 160 \\ \hline 380 \\ 190 \end{array}$$

$$\frac{29.5}{150} = \frac{19.7}{x}$$

$$120 = 33.3$$

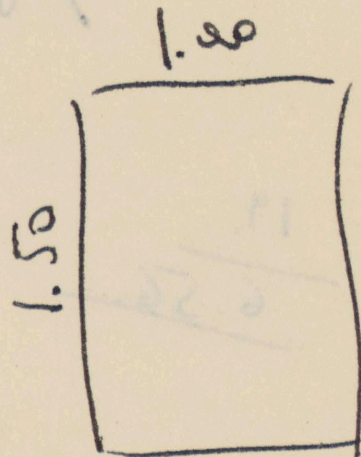

$$\frac{29.5}{150} = \frac{19.7}{x}$$

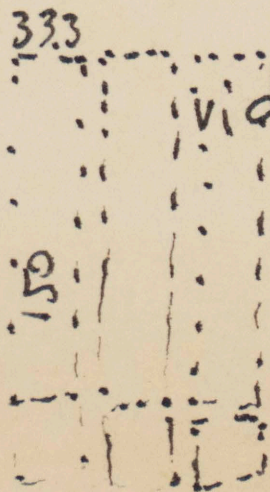
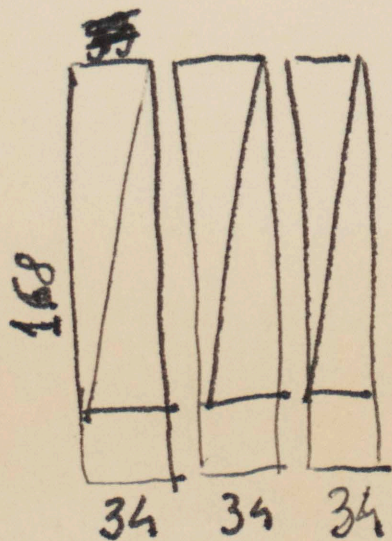

vidro 168 x 34cm = 3 vidros laminados
 Divinal bisoté.

$$\begin{array}{r} 200 \times 3 = 600,- \\ 150 \times 33.3 = 700,- \\ \hline = \end{array}$$

MARU - qab tu q' ester pronto?

20/ julho.

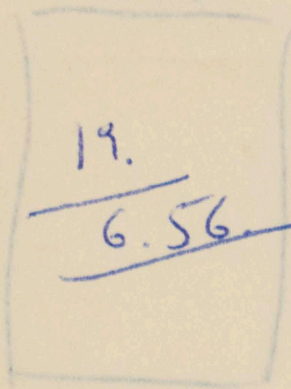

instituto de arte contemporanea

$$\frac{19.9}{160} = \frac{35}{x} = 28.8$$

pal: 167 x 30

$$\frac{19.9}{168} = \frac{35}{x} = 30.3$$

uido: 168 x 31

$$\frac{19.9}{16.7} = \frac{35}{x} = 30.1$$

instituto de arte contemporânea

$$\frac{29.5}{150} = \frac{16.5}{2} = \frac{83.83}{85}$$

85
(28.4)

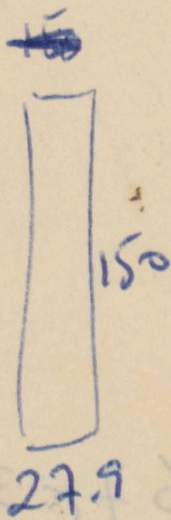
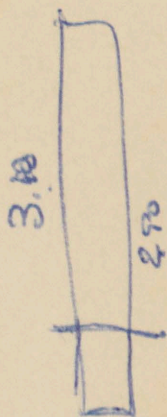
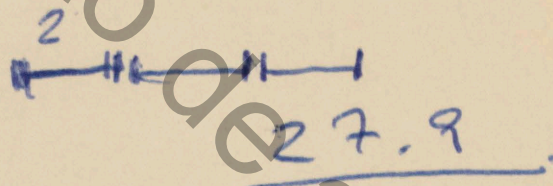

18 x 301: 201