

instituto de arte contemporânea

Projet elements P/Tour Module
Esc: 1:1 angles 50°
A 300 x 300 mm 17 unités
B 150 x 150 mm 64 "
C 75 x 75 mm 104 "

A
Hauteur Totale Alévement
3975 mm
LARGEUR 900 mm

CAMARGO sculpteur
27 rue Lepenquais
92 Malakoff FRANCE
567-5377
435-0247

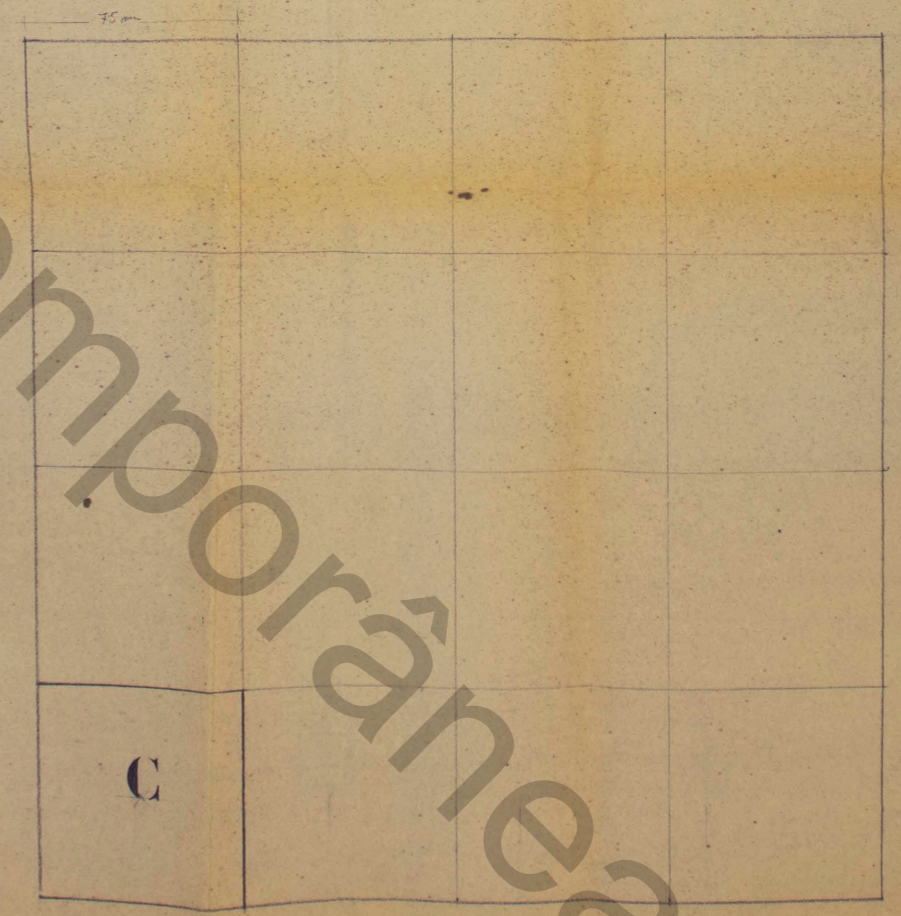
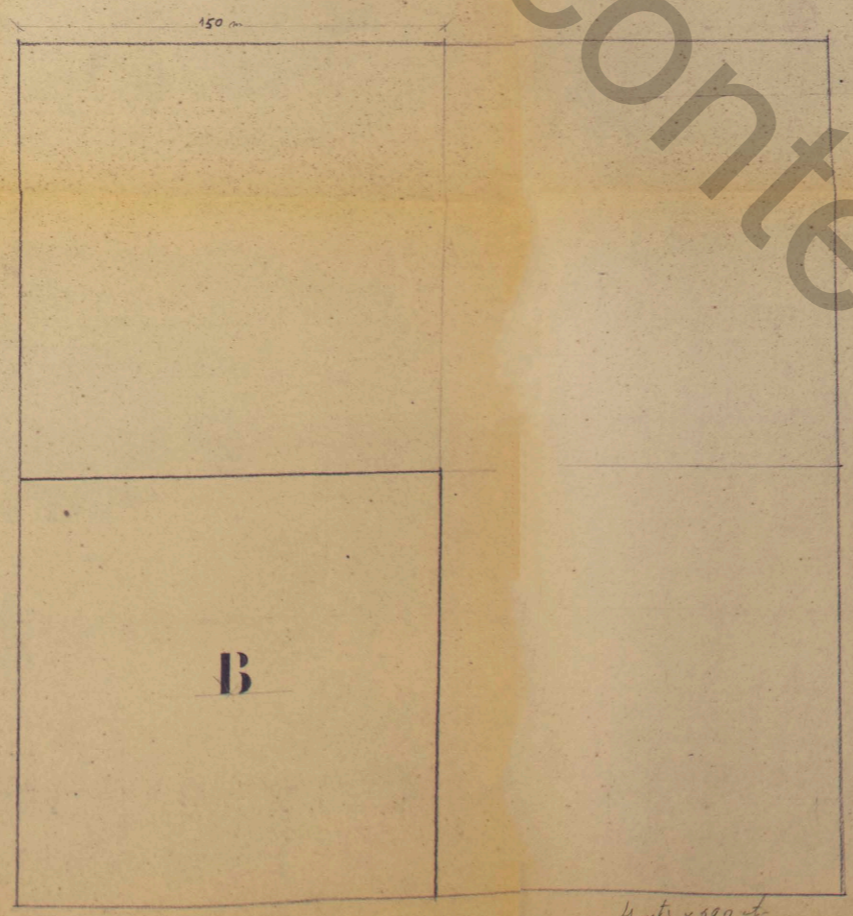
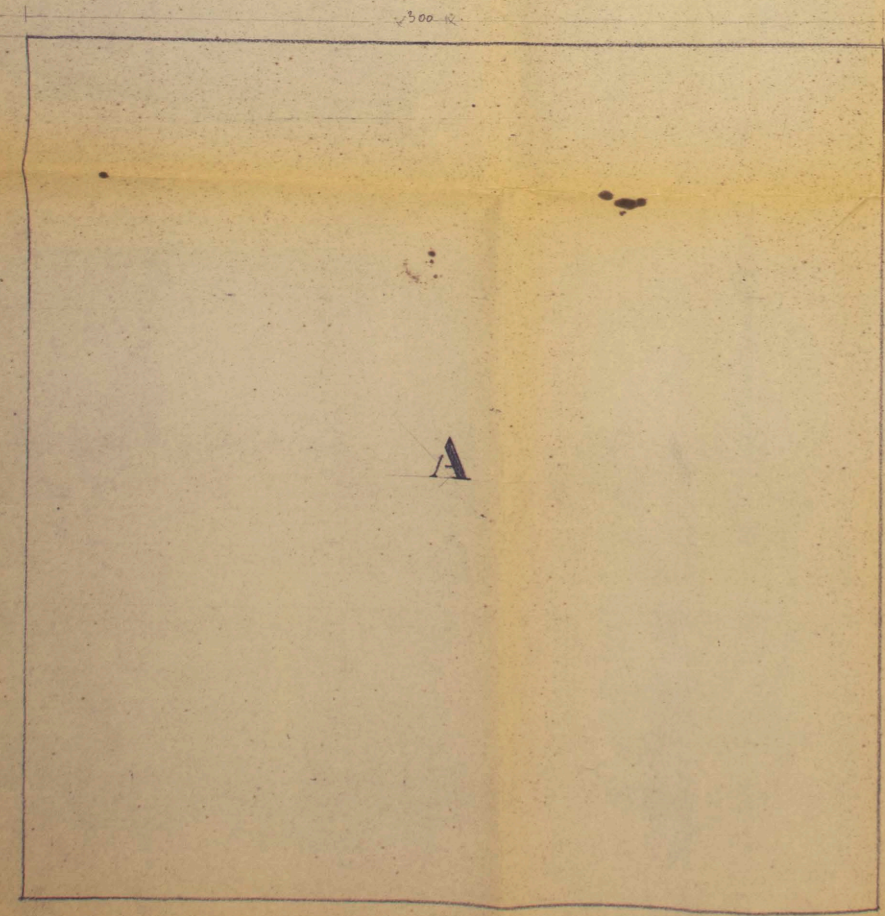
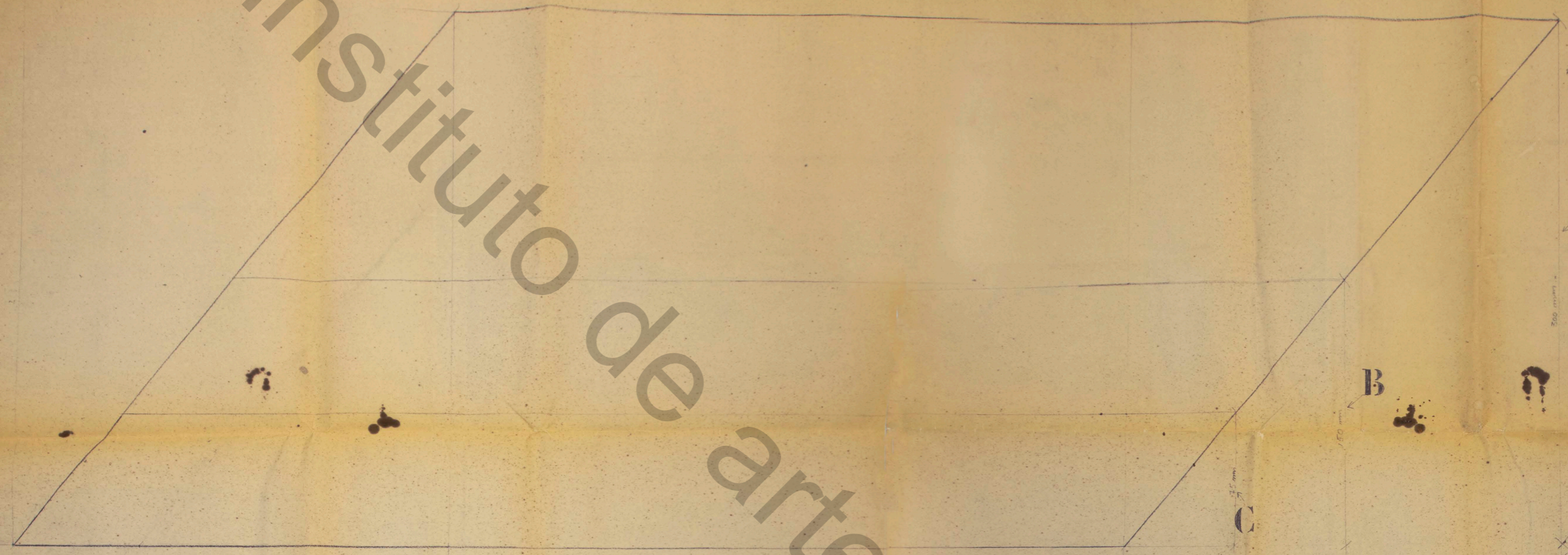

4 unités x 390 mm