

instituto de arte contemporânea

In case of loss, please return to:

As a reward: \$ _____

Case France Bral

2008

MOLESKINE®

info@moleskine.com • www.moleskine.com

instituto de arte contemporânea

Diâmetro Tubo 2mm

41 - (longo)

do 13.40

pel

25 - (curto)



vermelha

T1 = 3m

T2 = 2.50

IT.



falar. chape
1mm.

pel/o. atelier

chopinhas - mais

aruelas + grãos

quadrados

Willia —

- Cópia
- Ident.

- 1^o fev.

- dom.

- 2^o fev

3^o fev

4^o fev

5^o fev

6^o fev

7^o fev

* Domingo

- 2^o fev

3^o fev

4^o fev

5^o fev

6^o fev

7^o fev

* Dom

24 fev.

Instituto de arte contemporânea

13 dias.

10 - 50,00

~~500,00~~

250,00

~~100,00~~

250,00

105,00

450,00

200,00

SEFC:

Ayamense
Polimérica
Resina

Ayamense

MC-DUR 1300
n=1350

Fabricante: Emecê
- Baulchemie

- Transporte -

- Equipe - 6 dias - $\frac{2 \times 450 \times 4}{1800}$

Andre
Sarment
tel 2253
2112.

Felipe Filipe
99859933

- Apoio Juse - 3 pessoas

- Andares - 2 tons até 7.000 tons onde comprar -

Aluminum
especifico

- e-mail: atendimento

CNPJ

• Patricia@exempls.eng.br

• exempls@exempls.eng.br

• Ayamense polimérica pré-topica

Cia.

0.

1-2.100	+ 1.970
2-2.070	- 1.950
3-2.820	- 2.700
4-2.240	- 2.120
5-1.900	- 1.820
6-3.470	Arte contemporânea - 3.400

Arte contemporânea

instituto de arte contemporânea

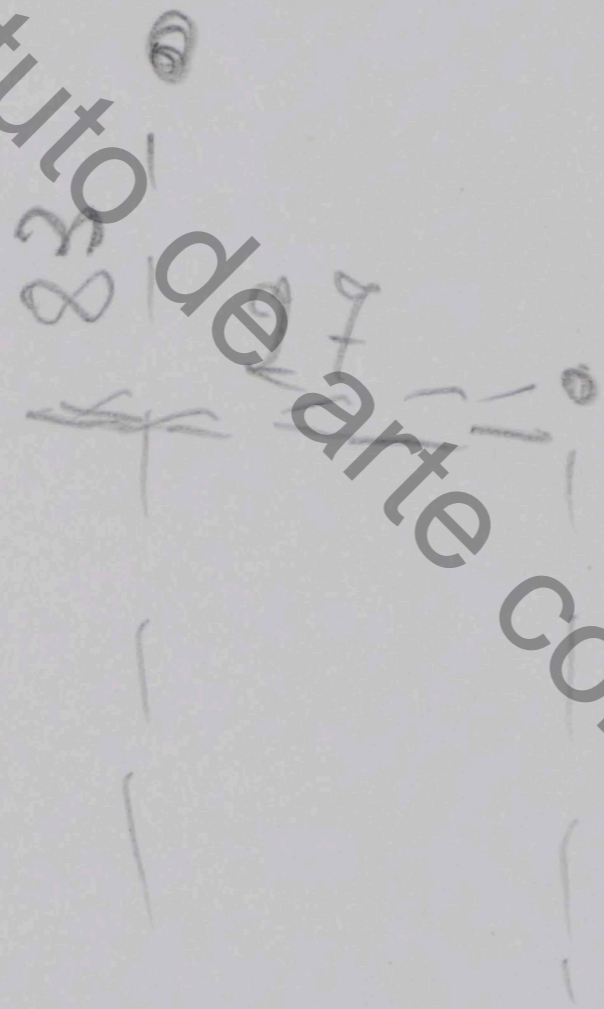

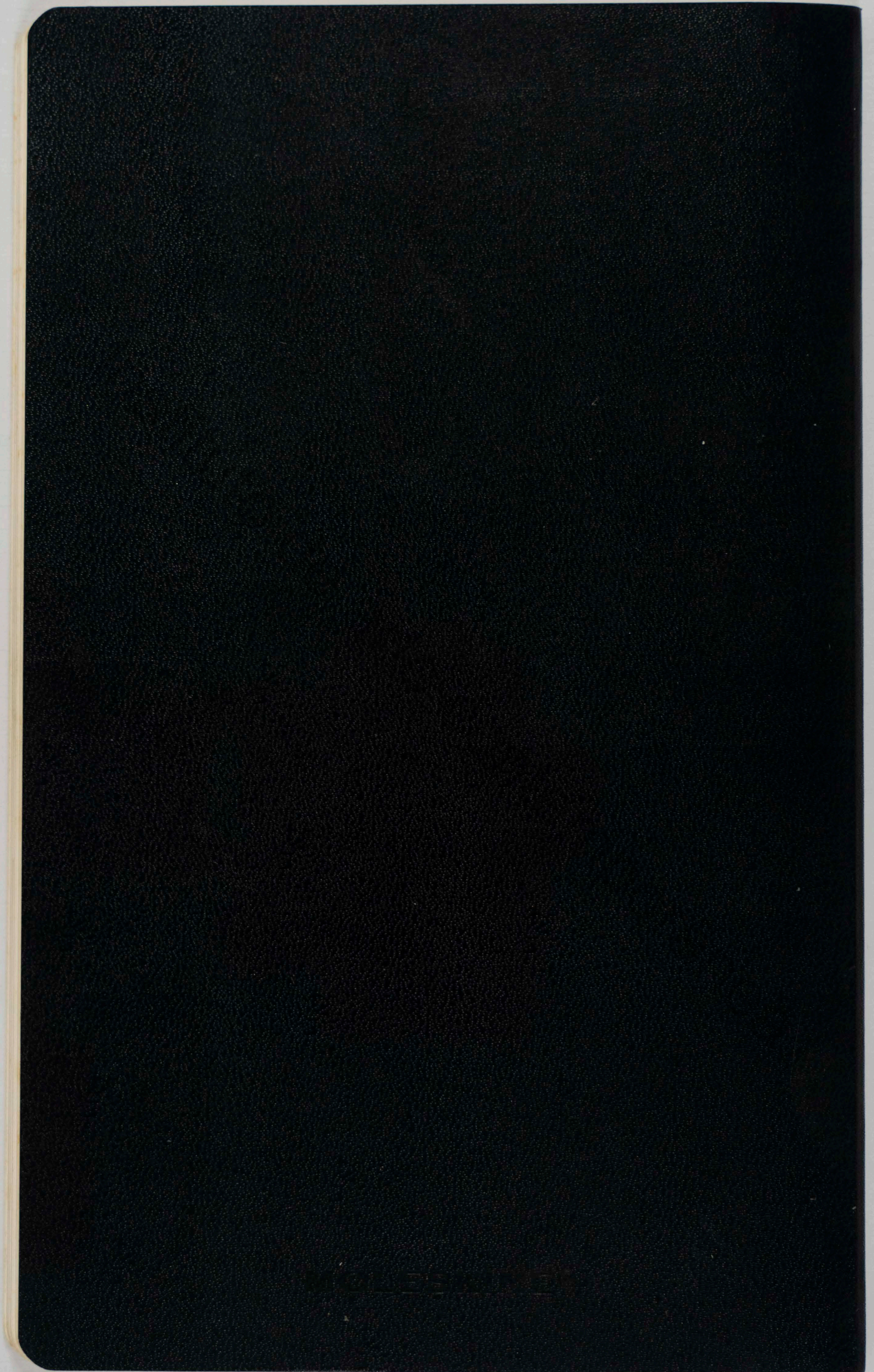

transparente

252 alt x 160 larg x 63

instituto de arte contemporânea

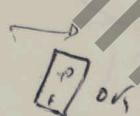

7.00

7.8

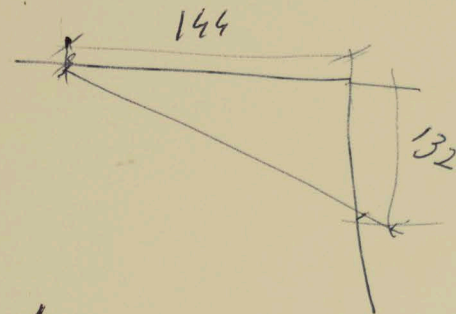
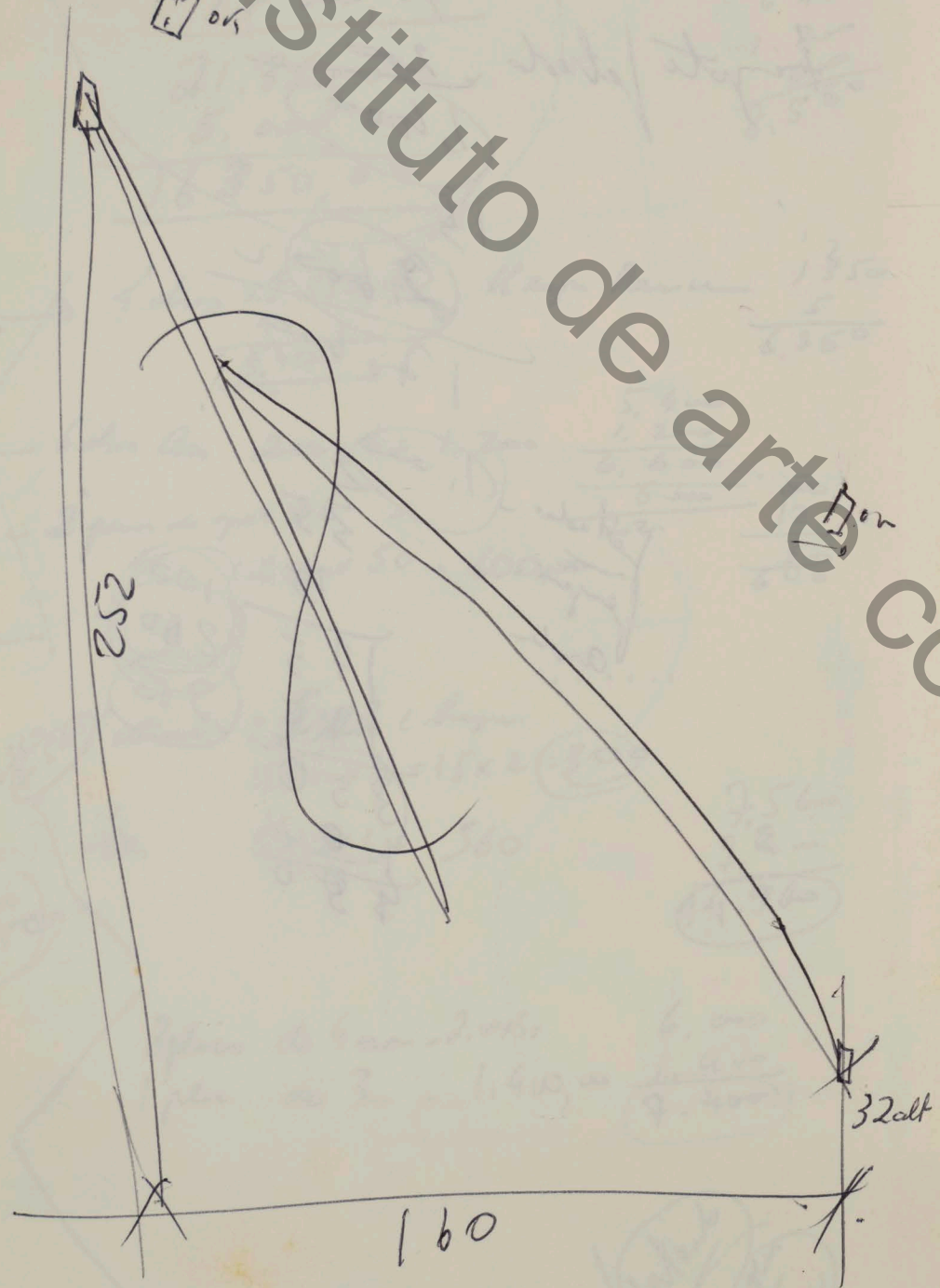

1m alt x

x per 132

$$\begin{array}{r} 21.350,00 \\ - 17.000,00 \\ \hline 21.350,00 \\ - 5.000,00 \\ \hline 16.350,00 \end{array}$$

$$\begin{array}{r} 45 \\ 4 \\ \hline 180 \end{array}$$

$$\begin{array}{r} 6750 \\ 1.200 \\ \hline 8.550 \end{array}$$

4 dias \times 1.350,00 = 5.400,00
 6 dias Am $200 \times 6 = 1.200$
 2 pias de gnd $\times 6 = 12$
 12 Vps $\times 50 = 600$

$$\begin{array}{r} 1350 \\ 5 \\ \hline 6.750 \end{array}$$

$$\begin{array}{r} 5400 \\ 1200 \\ \hline 6600 \\ 12 \\ \hline 6612 \end{array}$$

7.200 + 360 = 7.560
 8.550 + 360 = 8.910
 7.200 + 360 + 360 = 7.920
 alimentos: $5 \times 3 = 15$ (beje)
 5 dias $\times 3p = 15 \times 2 = 300$
 6 $\times 3 \times 2 = 360$

$$\begin{array}{r} 7.560 \\ 7.200 \\ \hline 14.760 \end{array}$$

3 pias de 4 mm - $2.000 \times 3 = 6.000$
 1 pia de 3 - $1.400,00$

$$\begin{array}{r} 6.000 \\ 1.400 \\ \hline 7.400 \end{array}$$

3 tubos: 1.000 + 3.000
 3 tubos: 1.000 + 3.000

Transporte Arzo / pia / 1.200

Transporte / chado - 200
 1.400

15
 2.600
 17.000

Transporte / pia / 1.200
 Transporte / chado - 35
 Transporte / chado - 5
 17.5
 17.5
 35.0
 100
 45.0

Contemporânea

instituto de arte

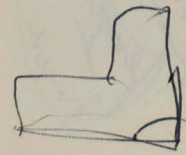
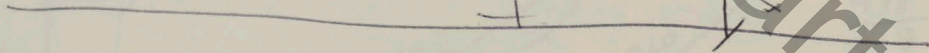

vermelho:

80 x 160

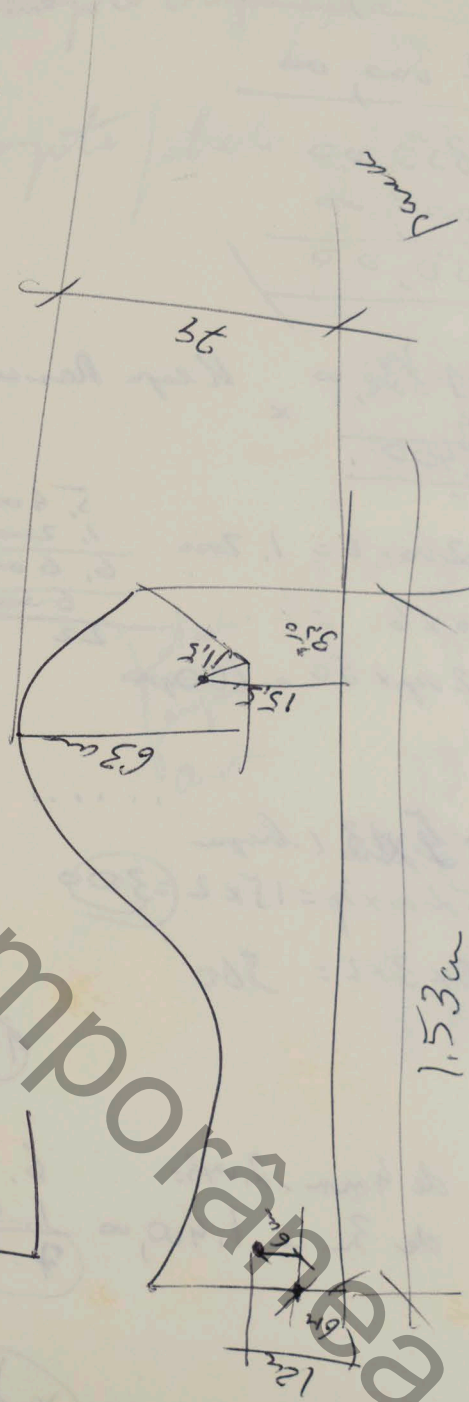

162
91
253

753
1091

250

1m. 91 alt x 153 ~~left~~ x 46cm

dia 17/11/09

Volume 2.64 de estreme

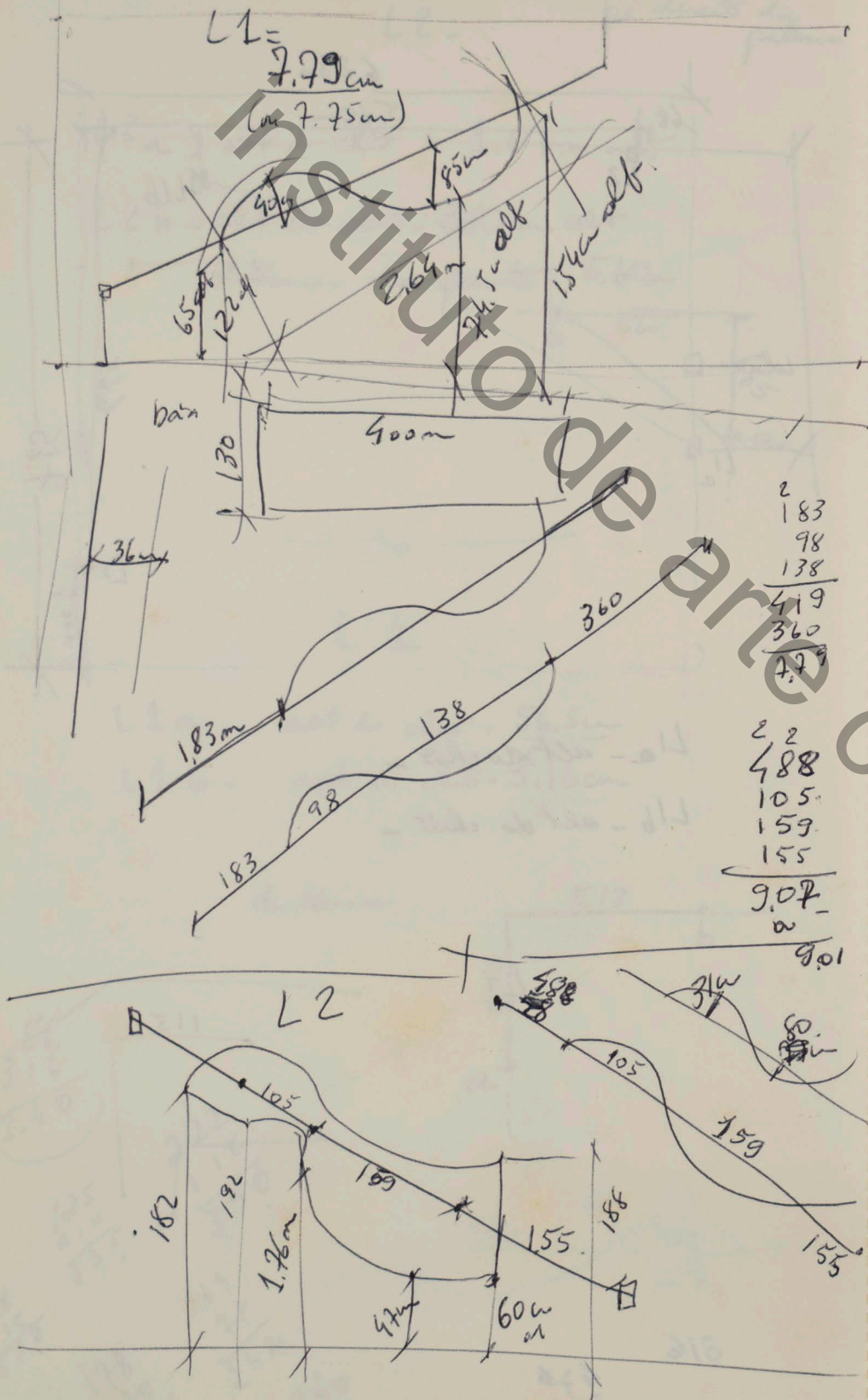

P. andar: Coa: 2.64

1. Quem somos? - grupo de expl.
 2. Bem nos criou?
 3. Qual nos destino? Apres.
 4. O que nos guia? A la de De.
 5. Quer desenvolver ritmo? no.
 6. Assim depressa canha e rapid se desenvolver rapidamente, aperece as la.
 7. Bem, o bonzinho, se afinou qd e f. em to a parte.
 8. o que o caracterize: epistola.
 9. valores utilit. - morar, a o que o qual qd.
 10. + perdidos.
- no tem a lixeira com a malha
 com os botes do criador
 predom. da epist. de out
 de rick. sil. o apert.
 de m. ut. f. ut.
- . de pers. fi.
 de Schroder. ut.
- a a conferen. na la de
 os p. p. - sobre a ut.
- Arian. mod. de m. d. e.
 kafedra. ut.
- II. Sabem p. p. p. p. p. p.
 a p. p. a p. p.
 def. e. e. e. e.
 no s. l. p. p. p. p. p. p. p. p. p.
 de b. k. a. t. e.

Contemporânea

dia 17/11/09

ACTIVA 3,63m

L2.

pe' dret de galeries

L2a - alt de chao = 1,07m alt

L2b - alt de chao = 3,40m alt

distancia de ponto = 5,60m

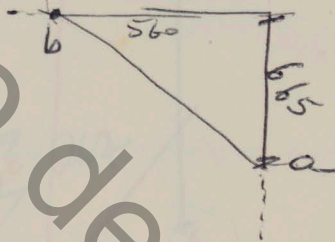

L1

L1a - alt do chao = 56,5cm

L1b - alt do chao = 3,16cm

distancia

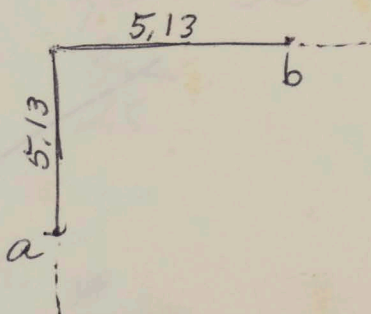

56,
3,16

2,40

222
118

340

2125
335

165
38

203

198
378

576

182
340
222

118

6,28
1,15

5,13

L1.

dia 17/11/09

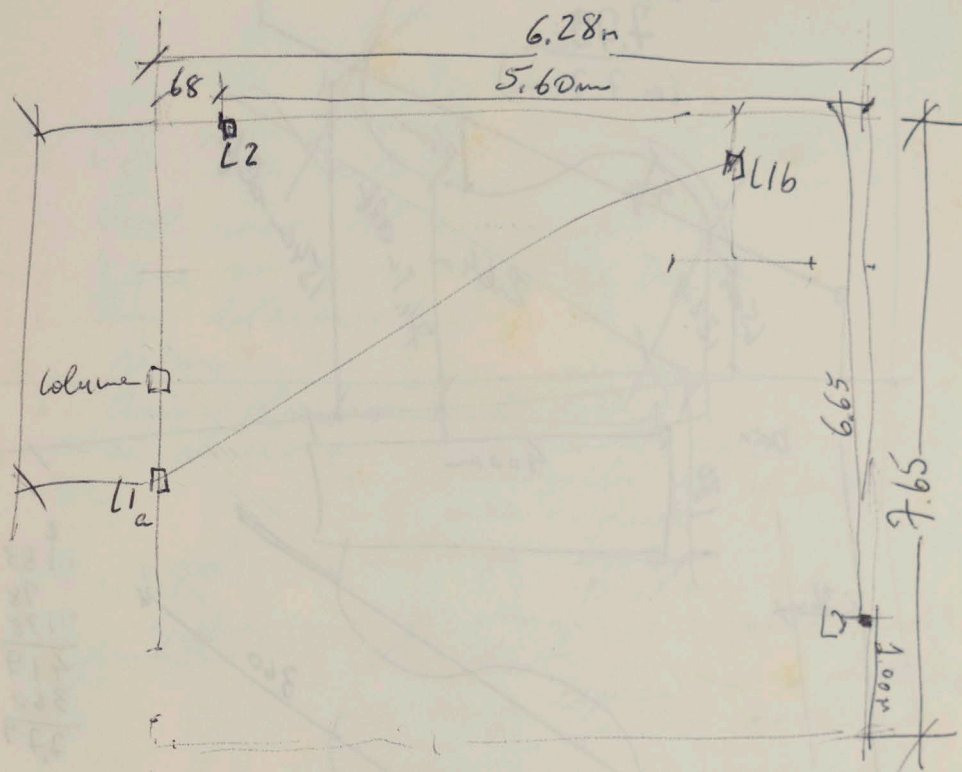

L1a - alt do chao =

L1b - alt do chao =

L1



316

426
316

160

L1
 antes de tirar as espigas do telhado

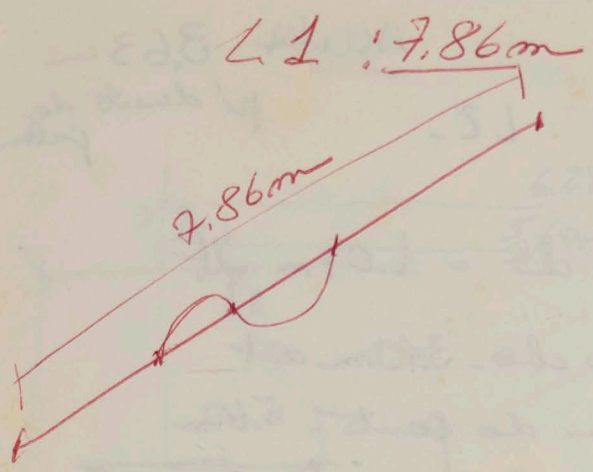
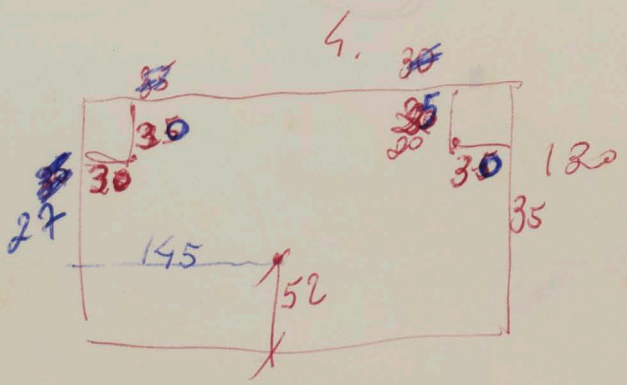
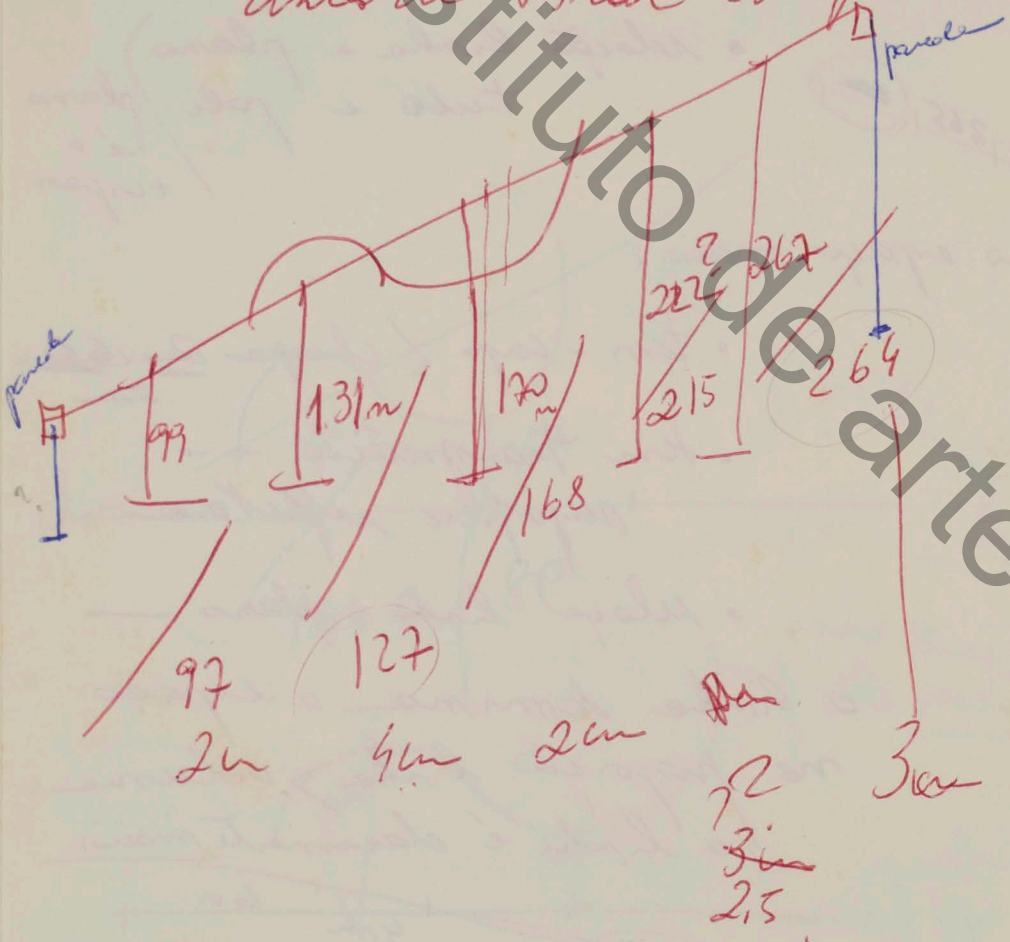

765

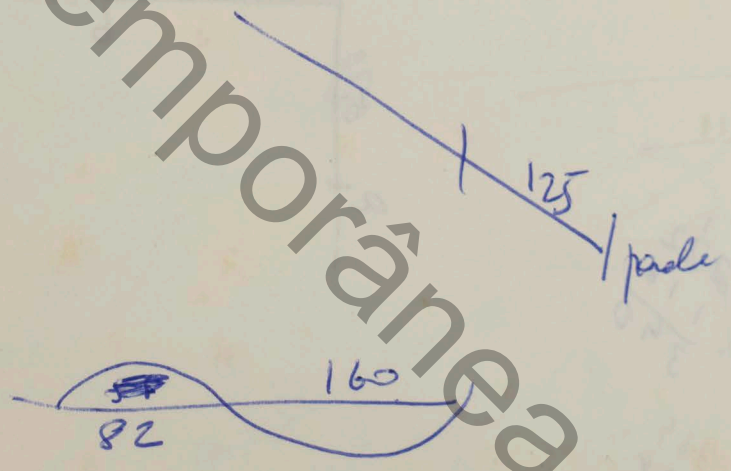
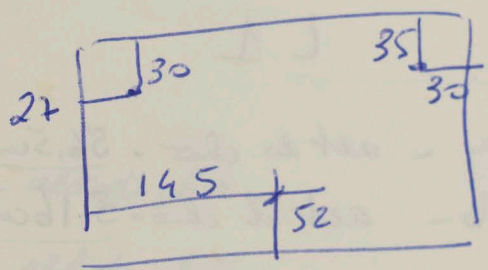

instituto de arte contemporânea

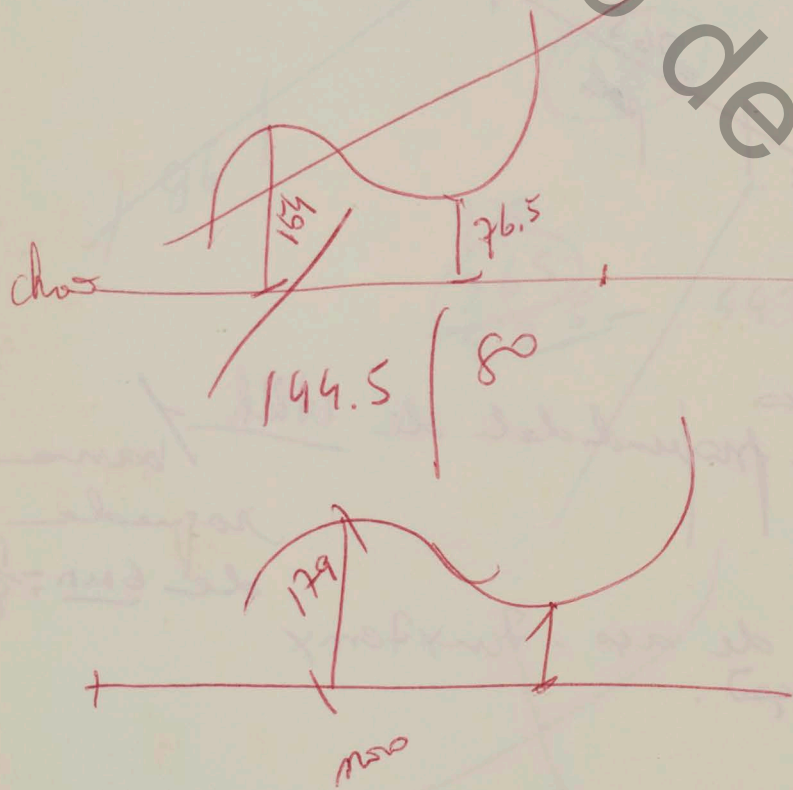

One line
 • Pat
 • Beth
 Pat

2000 = 55/64

tubo reto
 poli reto

no espaço, mesmo:

Mesmo sistema - linha reta
 plano curvo e retado

$170 \times 4,00 \times 3m$ chape + grama
 volume + densidade

tem + opacidade / polca

relação linha e plano
 tubo e poli plano
 e o
 + vidro

190 | 265

no espaço mesmo:

tem - corpo < chape $2m \times 60 \times 3,0m$

tem transparência e superfície refletora

relação linha e plano -
 a linha domina o espaço
 na proporção linha > volume
 a linha é claramente maior

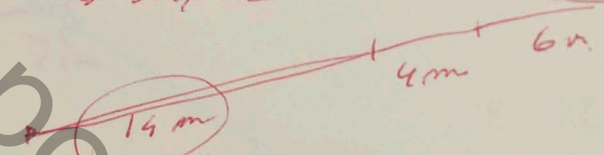

instituto de arte

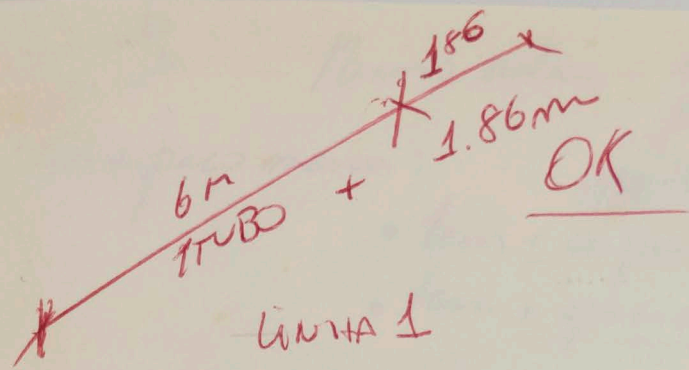
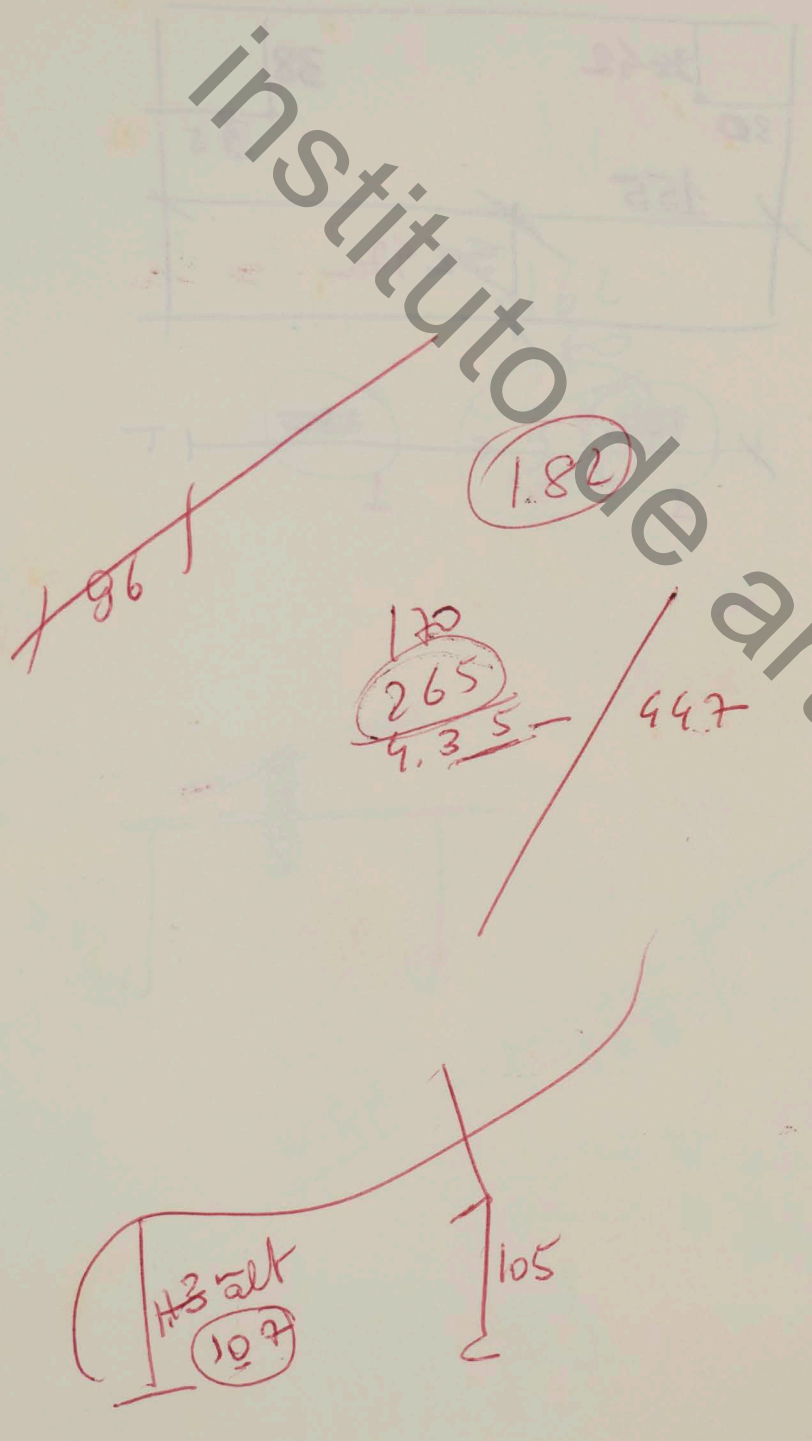

30f

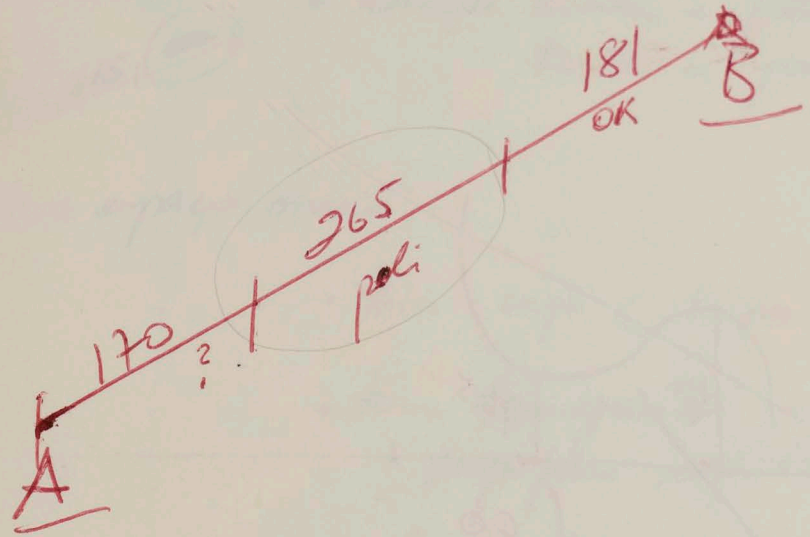

A - ponto baixo
sem de profundidade de utili / barras
requede
de 6mm = $\frac{1}{4}$

chapas de aço - $7m \times 7m$
p/ fixação.

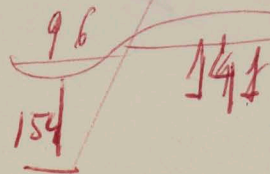

instituto de arte contemporânea

162

~~180~~

~~342~~

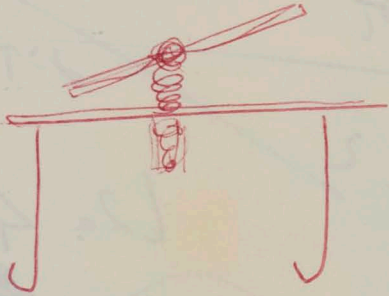

U1

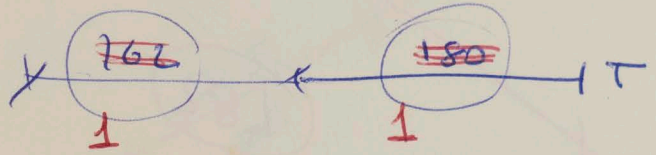
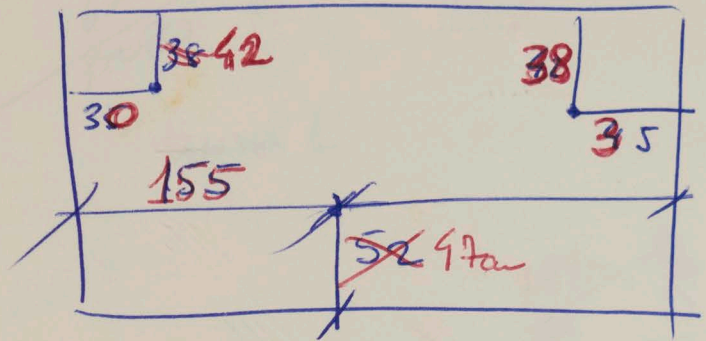

instituto de arte

L2

Contemporânea

L1

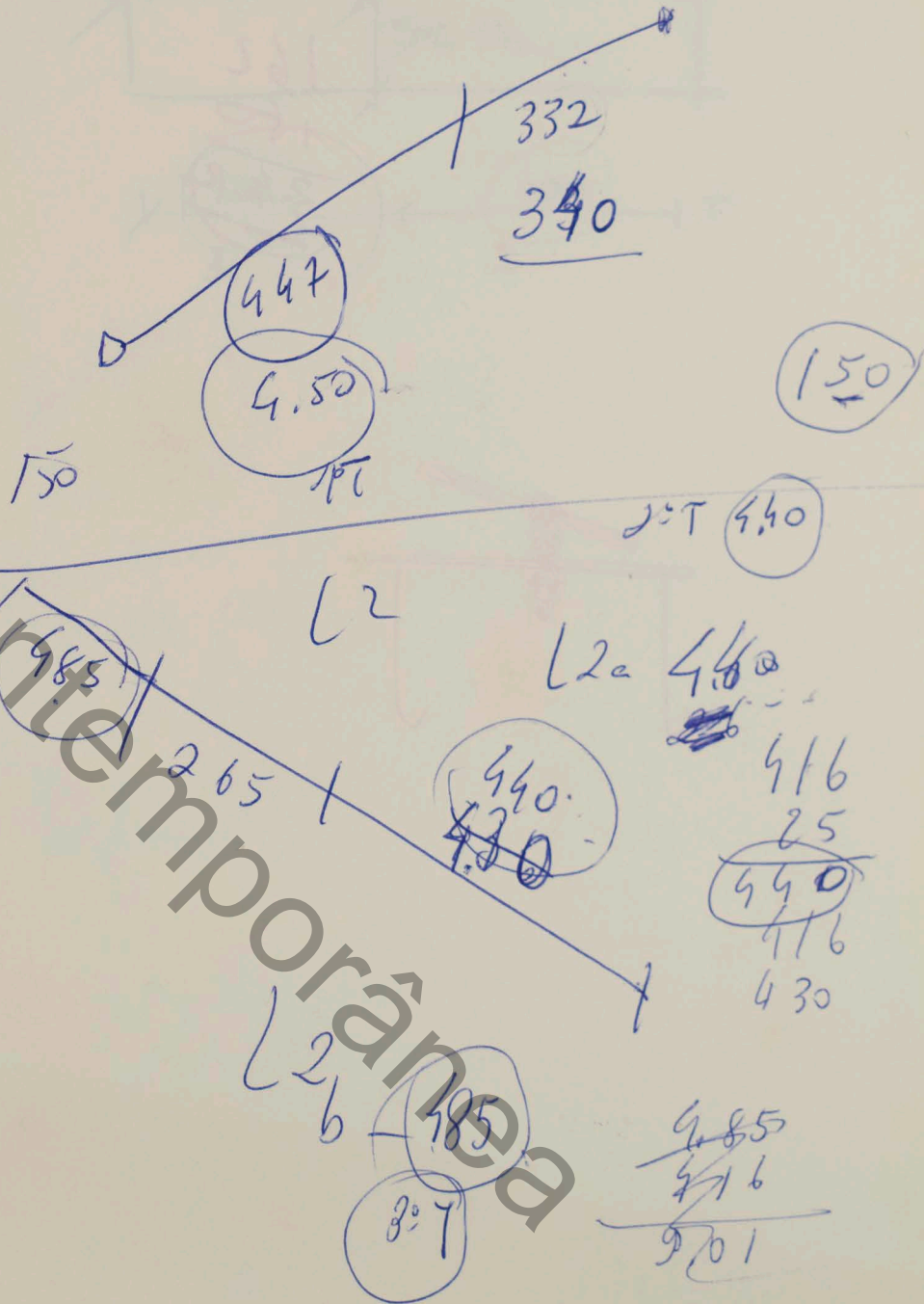

303
176

Instituto de arte

76
976
4.24

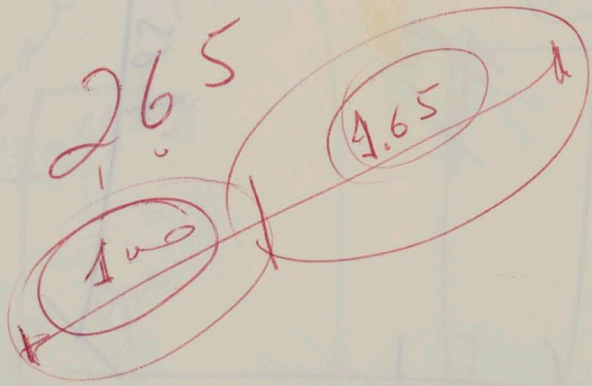

7,76 L1
9.030m L2

2ª feira

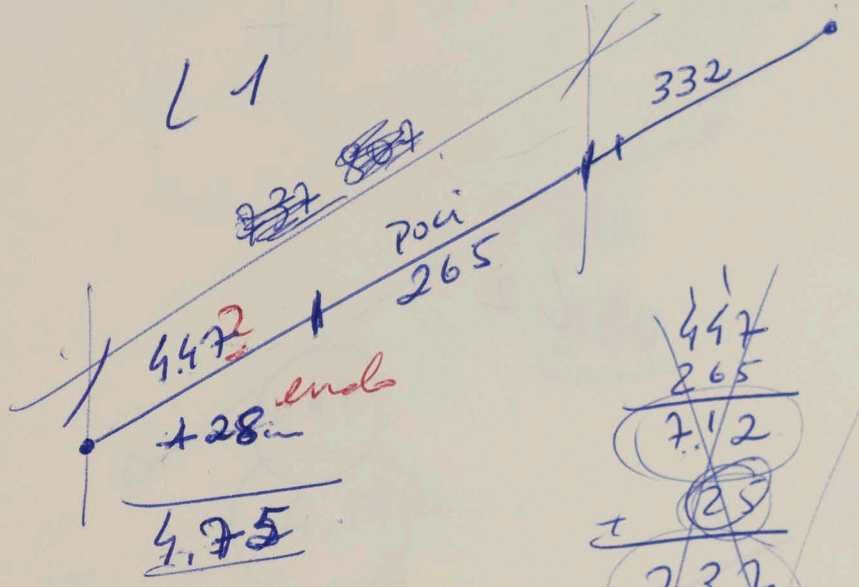

~~447~~
~~265~~
7.12
~~25~~
7.37

L1a - ~~475~~
L1b - 332

475.
332
807

L1a 500
L1b 350

Contemporânea

Instituto de Arte Contemporânea

8.15

~~28~~

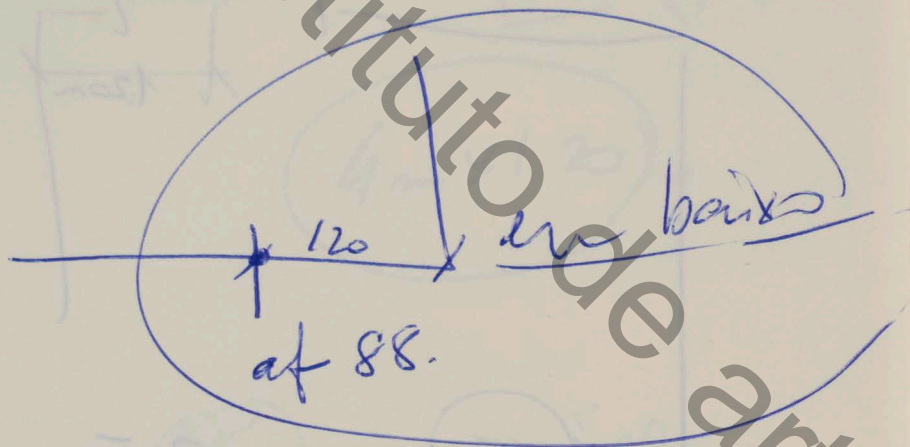

L2

315

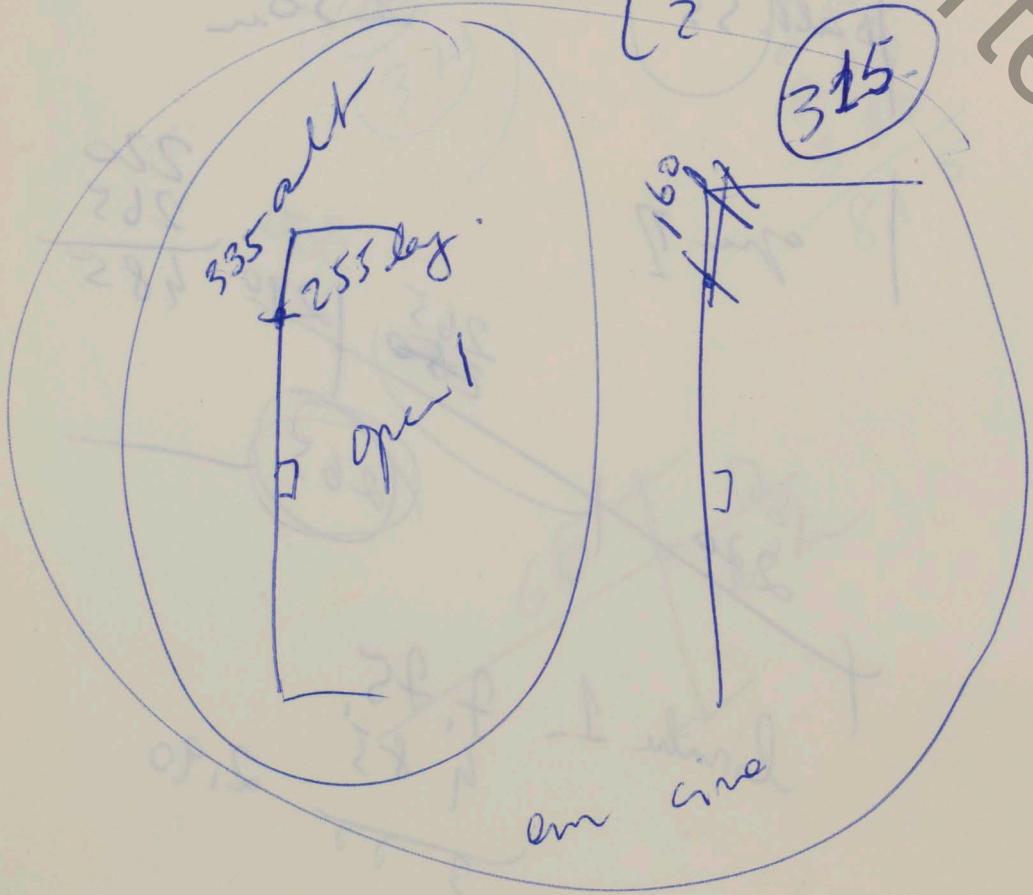

~~82~~

2.40

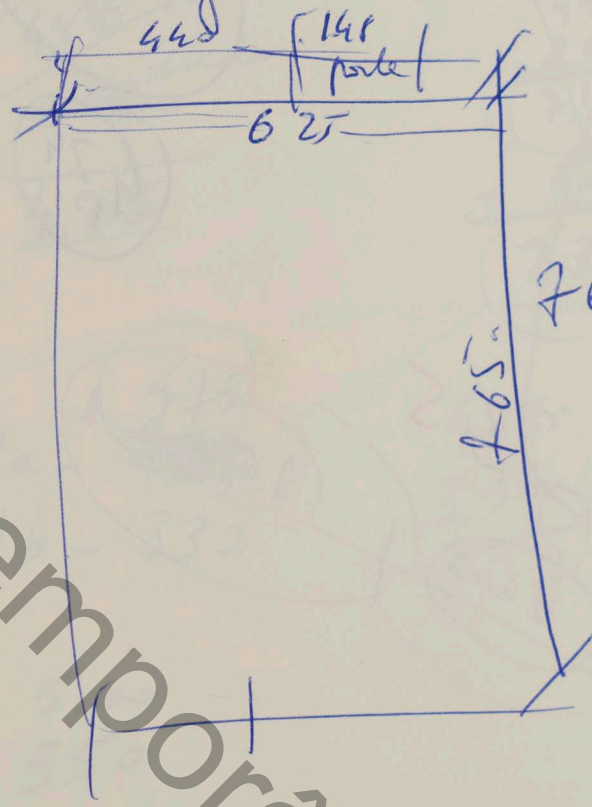
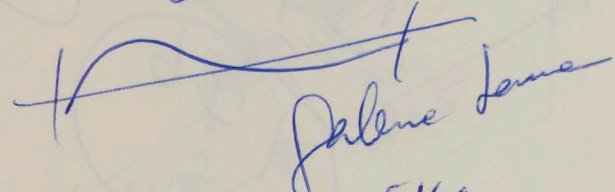

instituto de arte

chape

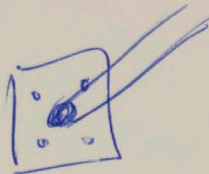

4 m x 1.20

3.5
3.15

220
265
330

815

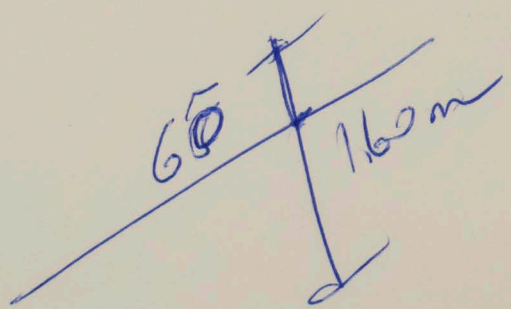

OK 7.75
L1 = ~~7.75~~ 8.15

OK 7.75
(24)

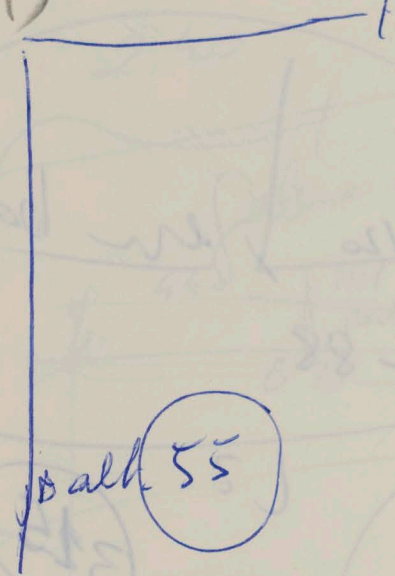
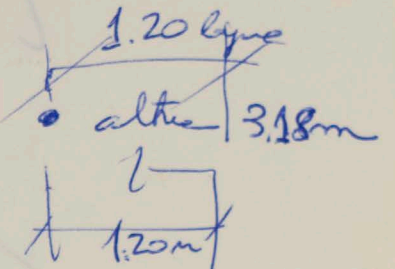

2.50m

que 1

220
265

485

265
250

300

290
265

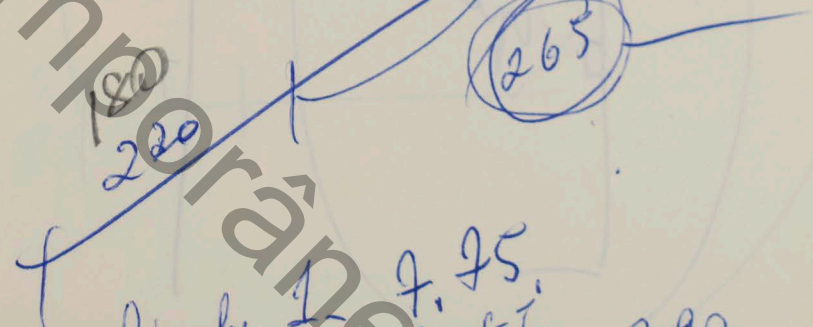

limbu 7.75
4.85

2.90

26

antes de tirar o apoio de madeira

ep^{no}

- 0 - 1.40 do cho. chope
- 1 - 2.80 do cho. ————— / 270 — 10m
- 2 - 1.86m do andaime ————— 4.31^m do cho. / 4.20 — 11m
- 3 - 1.60m " " ————— 5.32^m do cho. / 5.07 — 25m
- 4 - 2.15 " " ————— 6.85^m do cho. / 6.65 — 20m
- 5 - 1.40 " " ————— 7.8, 4.3m do cho. / 8.50 — ?
- 6 - chope 9.20m / 9.20

Ponte alta 9.20m ————

baixa 1.40m

Instituto de arte contemporânea

instituto de arte contemporânea

OK
L6 = 375

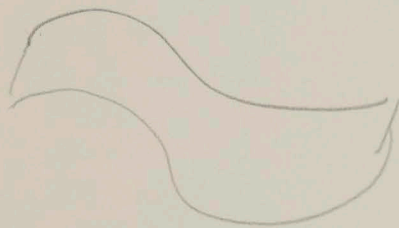
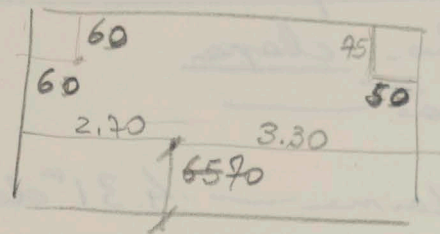

no espaço

instituto de arte contemporânea

L2

- tamento?

□ 10,00 aet do chao

□ ALT 0 - 2,20m do chao

capas de madeira

Apao 1	- 2,10m	- 1,970	- 40 ¹³ cm
2	- 2,070m	- 1,950	- 12cm
3	- 2,820m	- 2,700	- 12cm
4	- 2,240	- 2,120	- 12cm
5	- 1,900	- 1,820	- 8cm
6	- 3,470	- 3,400	- 7cm

7-
8-
9-
0-

aporo 1 - a qtr metros do 0

- de 2m em 2m altura do chao: -

0
-
-
-
-
-
-
-
-
10.00m

instituto de arte

- lei de justiça
 - lei humana?
 - lei divina?
- ambas
- Rosale }
Jeanne }
moral de
cada q pessoa
moral
- o perene, permanece
a nome

- lei divina, i material, se desenvolve q pessoa
moral de cada um, e assim a lei
humana. Está baseada no estado do
homem. Assim a evolução moral
pode ser de...

- o que vem a justiça?
o respeito aos direitos do outro.

X- se esta baseada na consciência, se

há ou não há controvérsias?
Por que pensar o homem não detém
o direito sobre o outro. Não define o direito
e nome o do outro. Não define o direito
o que é justo.

Como ter a certeza de que é justiça
de que se está sendo justo?

Pela mesma medida que fizemos ao outro
o que queremos que a nós seja feito.
Deixar com o outro um fortíssimo que
ajuda a ambos.

- com benevolência e não defeto e upper
pedindo nos falta.

- A lei de justiça se aplica a -
lei de amor e caridade

instituto de arte

22

- 1 — 224m
- 2 — 280m
- 3 — 340m
- 4 — 392m
- 5 — 456m
- 6 — 514m
- 7 — 575m
- 8 — 641m
- 9 — 708m
- 10 — 775m
- 11 — 847m
- 12 — 926m

865



L2

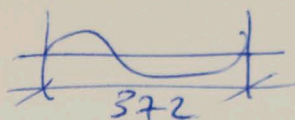

3.72m farnas do estuque no polo

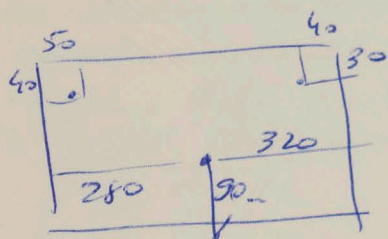
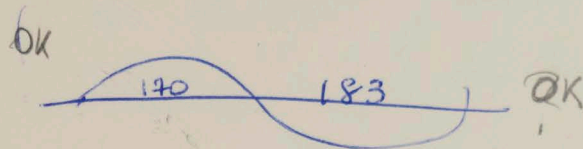

150
372
098

B.

L6

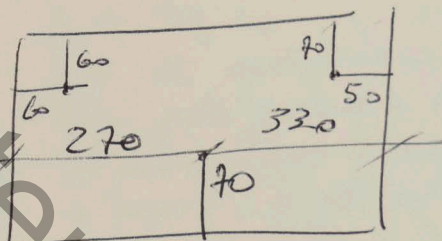

266 — T1
107 — TP
373
372 — P
745
105
850

107
372
105

13.26
8.50
4.76

13.26
863
4.63

266
25.
391
170
561
82
643

743
120
863

ATL do chão ao tecto

- 0 — 164 m
- 1 — 224 m
- 2 — 280 m
- 3 — 340 m
- 4 — 397 m
- 5 — 456 m
- 6 — 514 m
- 7 — 575 m
- 8 — 641 m
- 9 — 708 m
- 10 — 775 m
- 11 — 847 m
- 12 — 926 m

instituto de arte contemporânea



- 23.

- murelões de 2.00m a 2.00m

0 - parede -	alt = 1,64m do chão	
200 - antes		depois
1° 2,28m	_____	2,24m
2° 2,90	_____	2,80m
3° 1,78	_____	1,64
4° 1,67	_____	1,50
5° 1,79	_____	1,59
6° 1,65	_____	1,43
7° 2,06	_____	1,82
8° 1,95	_____	?
9° 1,58	_____	1,36
10° 1,71	_____	1,56
11° 1,35	_____	1,29
12° 9,26 do chão (parede)		

alt. até o chão

alt. do tubo até o patamar do andaime

instituto de arte

Contemporânea

21

Alum Madeira

instituto de arte contemporânea

21

antes de TIKAR

o grupo de madeira

ponto 0

(NAO) ESTAO DE 2m 2m

1°

2°

3°

4°

5°

6°

7°

8°

9°

10°

11°

12°

13°

14°

alt. do o chao

alt. do tres alt

o galiao do andar

2m

12m

ponto 0° - LS
 de 2m/2m

flecos visual maior
 Instituto de

onde parece
 flete maior

0 - parede branca
 antes

depois

	antes	depois	
1°	228 ⁸	2.24m	
2°	290	até chão - 2.80m	
3°	178	depois 164	3.40
4°	167	150	397 (17)
5°	159 (17)	OK 159	456 (20)
6°	165	+ 143	544 (22)
7°	206	até o chão do andar	782 (24) 575
8°	195	?	641
9°	158	136 (22)	708
10°	171	156 (25)	775
11°	135	129 - (6)	847

n° 12
 parede
 alba

onde está o pedr?
 qual a altura do ponto 12°

LS
 de 2m/2m

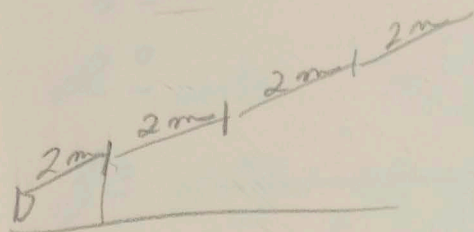

Antes de tirar os calços/apoi
 de mediana
 - após o rebate
 224

1°	228m	
2°	290m	(do chão)
3°	354m	(do chão)
4°	416m	(do chão)

Arte Contemporânea

instituto de arte contemporânea

L1.

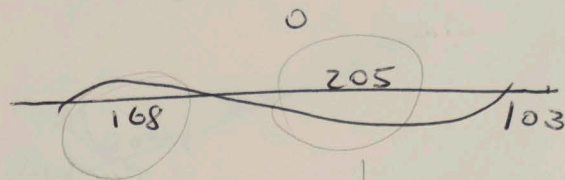
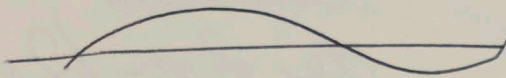

↓ muito longe
pelo subque mais

L5

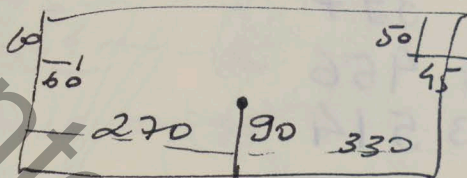
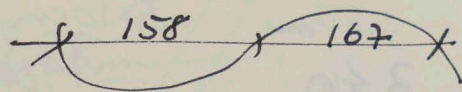

Instituto de arte contemporânea

Linha do tempo

• n: de fotos.

		40x50	30x40
1	luis Antonio - 2	1	
2	Aquide - 2	1	
3	H.D - 4	2	
4	V. Vitoria - 4	2	- fora - luz
5	CCBB - 4 (2,2)	2	- poli e temp.
	- MENCOSUL - 1	X	
6	Documenta - 5	3	- fot/hor/fora
7	BENE - 2	3	
8	WAO	2	
		<u>16</u>	

• ampliações: ~~em~~ 100x70

8

paredes sala / escritório -

9 metros = 8 metros
lado metro 2

16 fotos

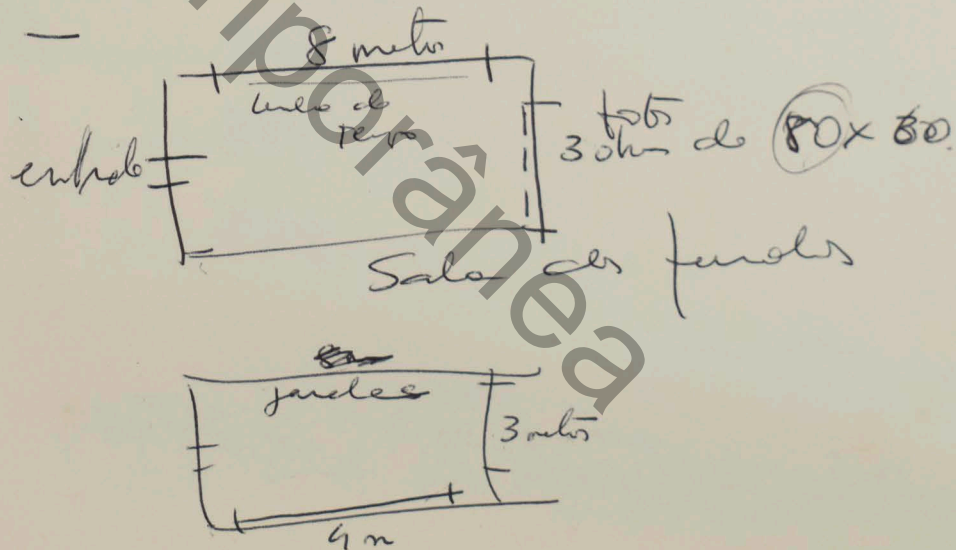
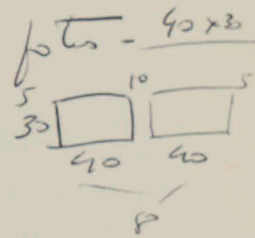

instituto de arte contemporânea

L1

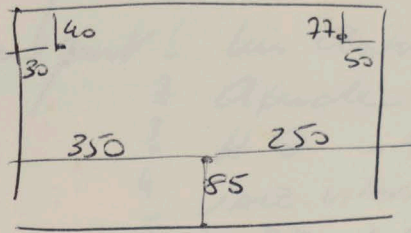

L5

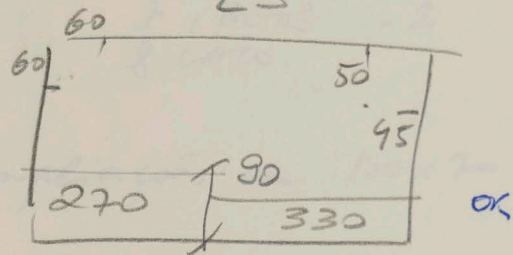

L2

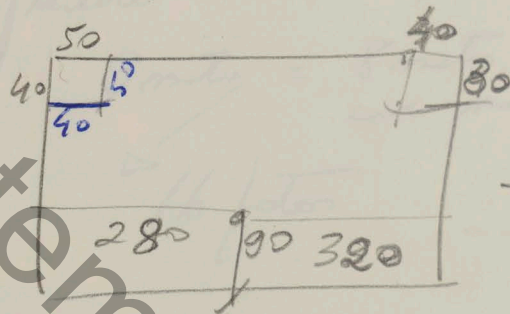

instituto de arte

260
320
180

290 - 3
310

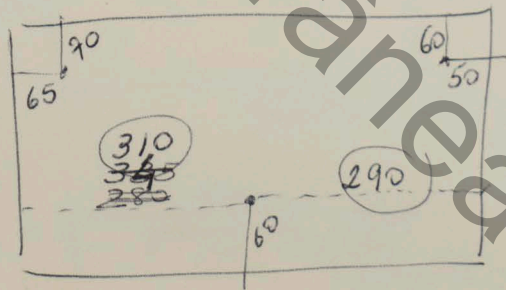
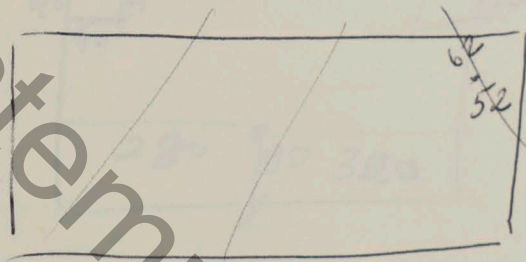
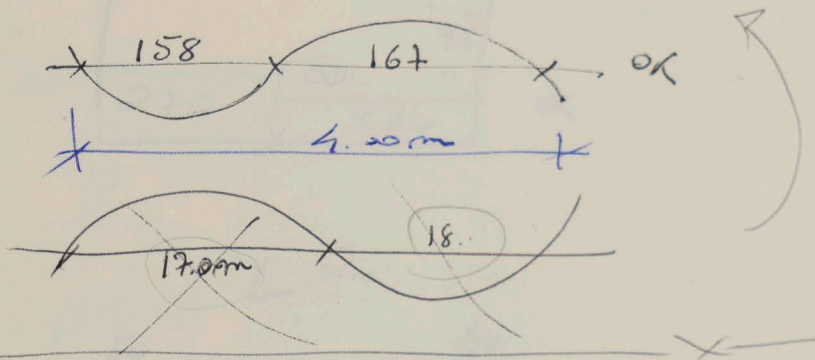
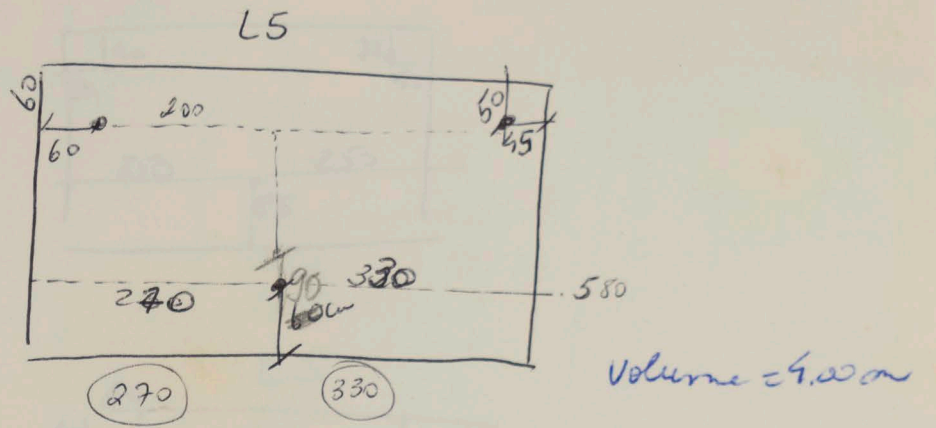

instituto de arte

~~opcao 1~~

~~SAB/ DOM - ANDAIME~~

L3
L2

~~2^o f 27 ANDAIME~~

oper 2 OK

SAB / DOM

- 2^o F - equip. tec.

L3
L2

- 3^o F

- 4^o F

- 5^o F ANDAIME

L4
L6

- 6^o f $\frac{1}{2}$

→ SAB / DOM 2^o f, 3^o f, 4^o f, 5^o f

instituto de arte

2º f.
3º f.
4º f.
5º f.
6º f.

SAB.
DOM.
2º f.
3º f.
4º f.

→ 3º f - 12.00 - L1 legs
L5 leg

3
21.00h
9.30h
11.00h
12.00h

→ SAB/DOM. - demora 2
mota nota 2
→ 2º feira - mota + 2
3º f - 8.00 - da tarde
depois do almoço.

31/13 L2.
14 L3.
15

6/66 L4
Feb 17.

2º f L6

4º f - 21/10

22
23
24

Termino da instalação
20

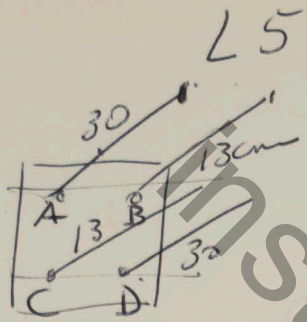

$AD = 30m$

- 15. argamasa
- 14. ~~pedra~~ tijolo firme

$B/C = 13m$

- 15. argamasa
- 14. ~~pedra~~

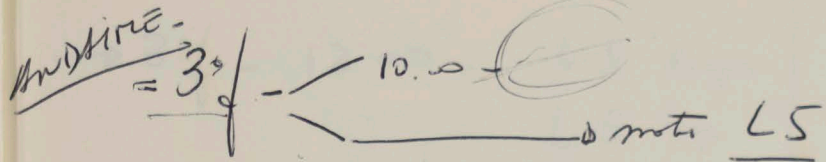

4. f. mata volume to L1 - +

5. f. linha L5.

6. f. linha L5 -

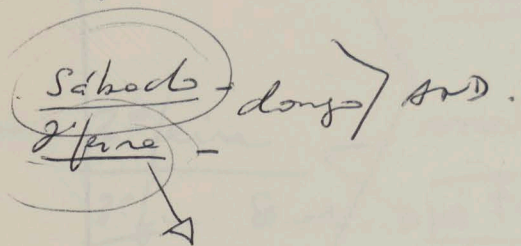

2 de plantas

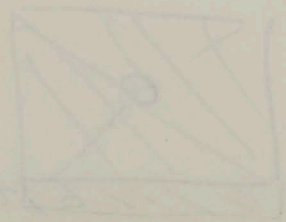

instituto de arte

contemporânea

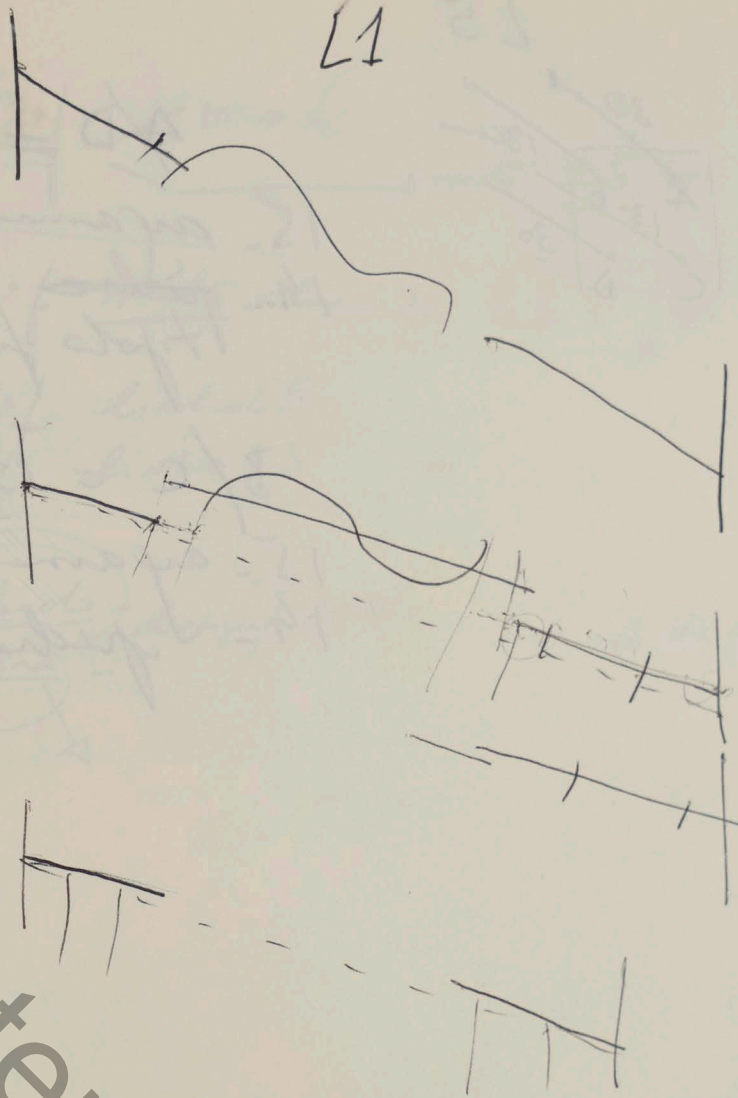

3
2,5
6
150

aprox do tubo
18 metros = 6 caibros - 10cm x 10cm (escora de pinus)
6 BASES

6 bases de 60cm x 60cm - 6.
- 1 caixa de parafusos Phillips 5cm de larg x 40

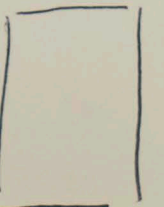
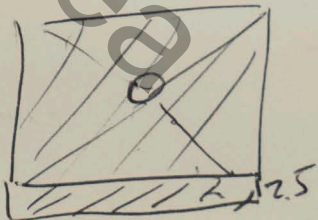
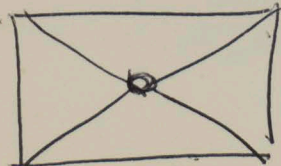

instituto de arte contemporânea

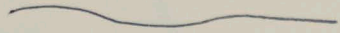
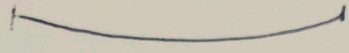

instituto de arte contemporânea

[L1] parede
boca 12 = $\frac{1}{2}$ polegada. 60cm de comprimento

- entrar 30cm na parede
- 40cm na pedra

- 30cm de HILTI em cada furo
- enroscar o parafuso com profundidade $\frac{5}{16}$

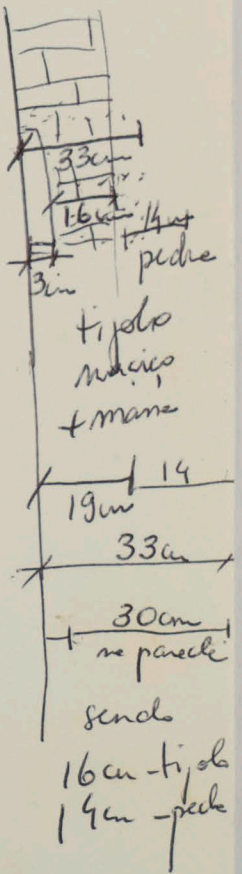

L3 - entrar só 18cm;
3cm do rebaixo
+
15cm de tijolo maciço

instituto de arte contemporânea

• Lançamento catálogo.

↓
- Teço 26 janeiro

- • Desmontagem

↓
22 - 1º março. na

→ 1 - 7. março. sim

• VINDA SONIA

15 (5/1) à tarde.

12 - 16 - 6ª feira
17 - sábado

Decisão:

1. lançamento do catálogo - 26/1/10 3ª
• visita gráfica?
• mesa de Sonia?
• utens
2. desmontagem -
1º o 7 de março.
(cole em Vitória/Vil. Vally/Vale)
- 3.



instituto

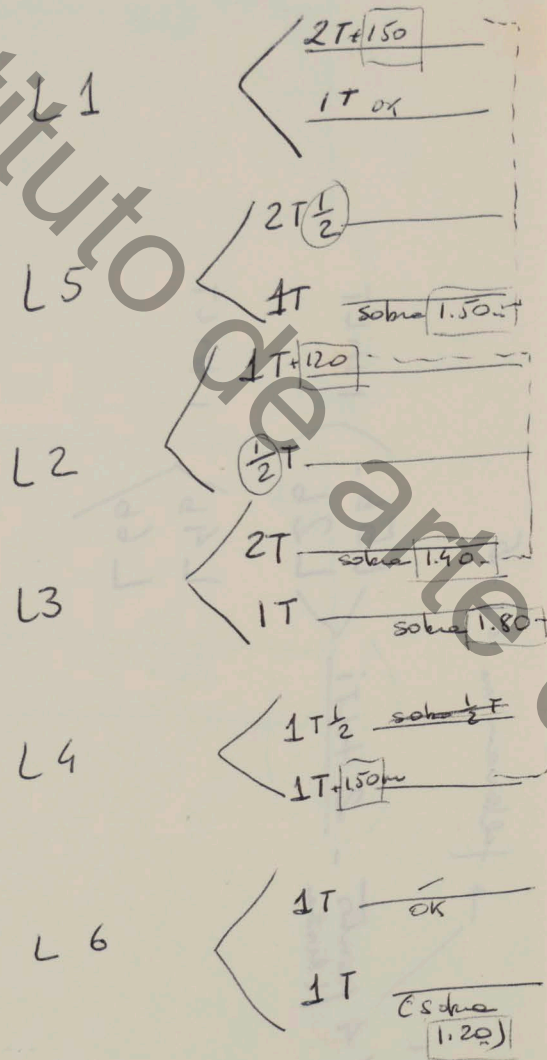

$2T + 1T + 2T + 1T + 1T + 2T + 1T + 1T + 1T + 1T + 1T + \frac{1}{2} = 16T.$

$L1 - 13.40 \xrightarrow{4.5} 2T+150$
 $5.87 \xrightarrow{1T} T. 23.75$

$L5 - 14.56 \xrightarrow{4.5} 2T \cdot \frac{L}{2}$
 $4.50 \xrightarrow{\frac{1}{2}+150 \text{ (sobra } 1.50 \text{)}} T. 23.56$

$L2 - 7.10 \xrightarrow{4.5} 1T+1.20$
 $2.66 \xrightarrow{\frac{1}{2}T} T. 13.26$

$L3 - 10.60 \xrightarrow{4.5} 2T \text{ (sobra } 1.40 \text{)}$
 $4.20 \xrightarrow{\frac{1}{2}T+120 \text{ (sobra } 1.80 \text{)}} T. 19.30$

$L4 - 8.75 \xrightarrow{4.5} 1T \frac{1}{2}$
 $7.50 \xrightarrow{1T+150} T. 20.75$

$L6 - 5.73 \xrightarrow{4.5} 1T$
 $4.72 \xrightarrow{\text{(sobra } 1.20 \text{)}} T. 14.95$

Contemporânea

instituto de arte



→ falavam me 27-5

1411

6 pontos (Linha) - / 4 pontos (Linha)

2 1411

1 1411

L56 -
L26

-2: L36
L16

L46
L66

1 1411

Contemporânea

instituto de arte contemporânea

11

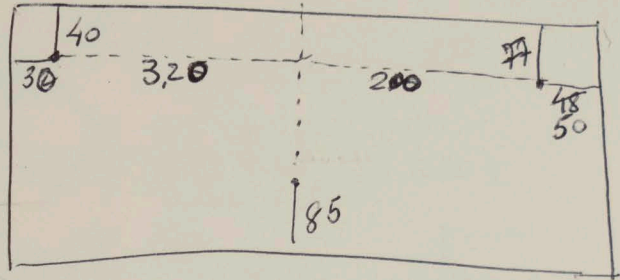

320
200
32

5.52
48

6.00

320
200
80

6.00

11

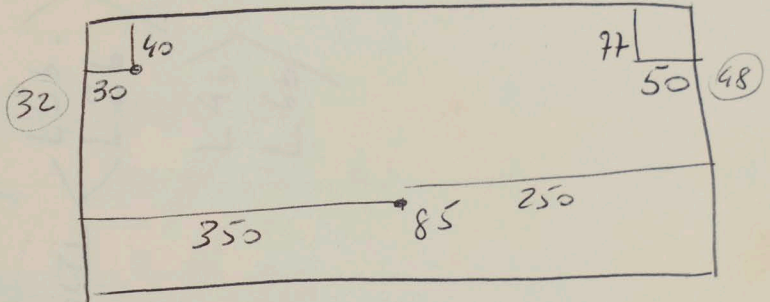

ne vermilha -

riçishe - jekade

jekade chape intene

jekee - limy -

- 1/2 grade

instituto de arte contemporânea

Dimensões das linhas

L1. (longa)

chas 13.40m poli

Poli (4.50)

poli 5.87m teto

L5 - (longa)

