















Legend

- | | | | | |
|---|--|---|---|--|
|  Stairs |  Information |  Coat Check |  Audioguides |  Bicycles |
|  Elevator |  Ladies' Room |  Telephone |  Restaurant |  Closed to the Public |
|  Escalator |  Men's Room |  Smoking |  Handicapped |  Special Exhibitions |

2 Second Floor

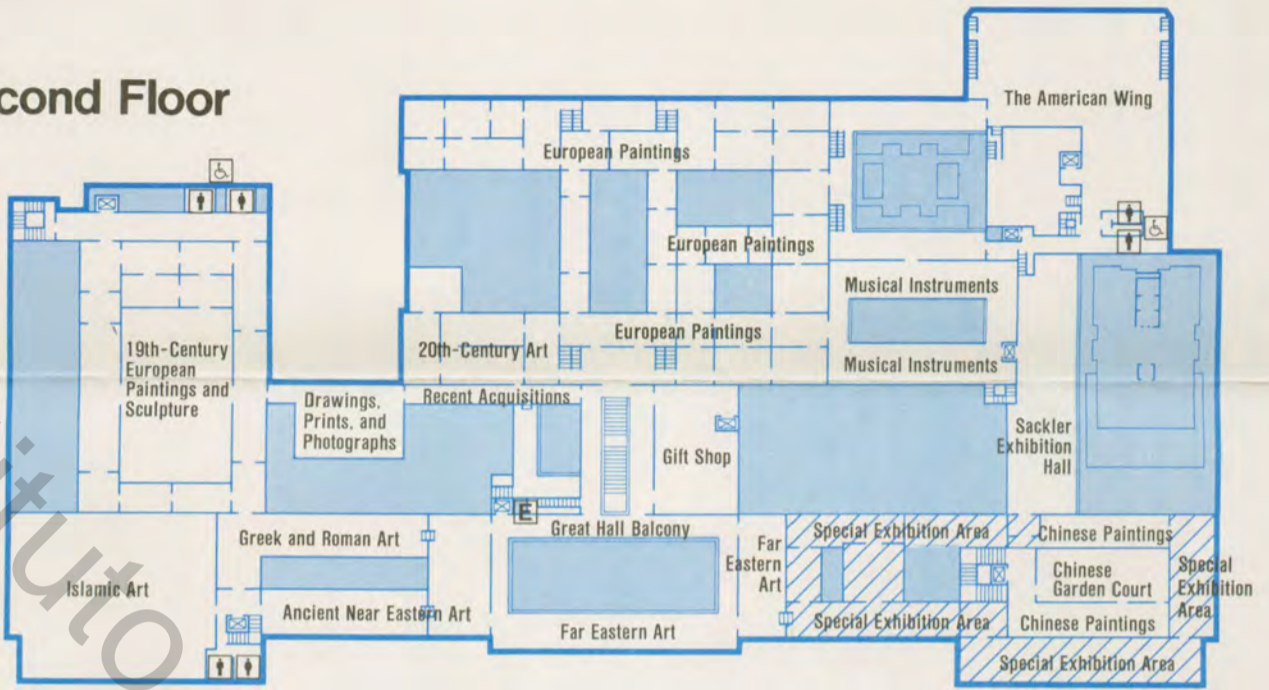

1 First Floor

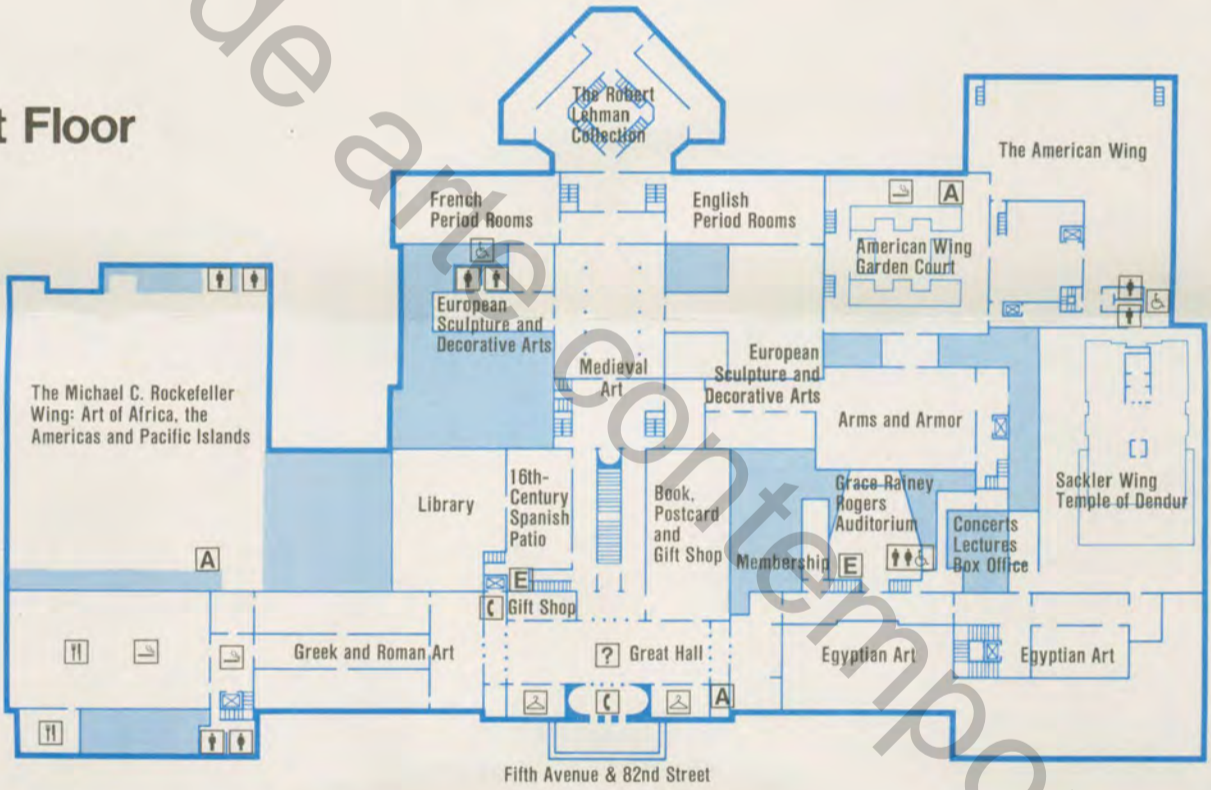

G Ground Floor

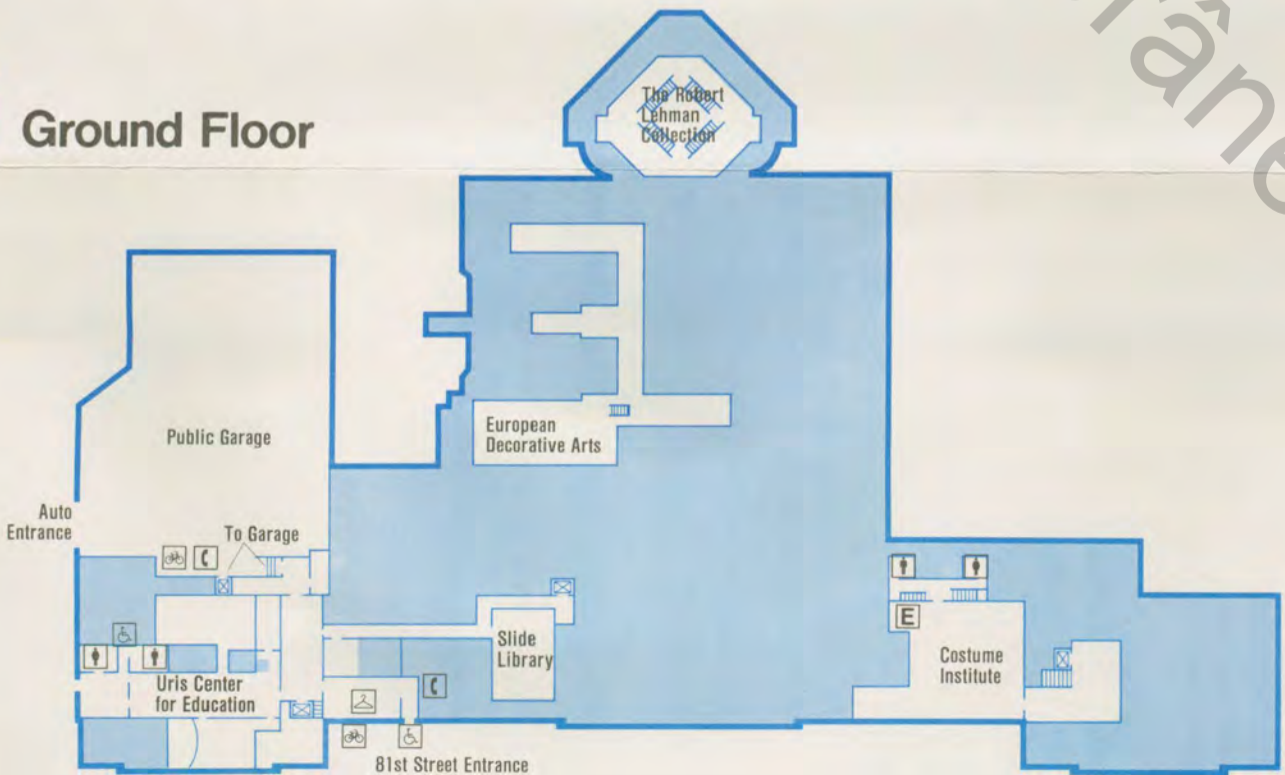

An Introduction

The Metropolitan Museum of Art, which was founded in 1870 by a group of civic leaders, financiers, industrialists, and art collectors, moved to its present location in Central Park in 1880.

Today the Metropolitan is the largest museum of art in the Western Hemisphere. It occupies 1.4 million square feet, extending from 80th to 84th streets on Fifth Avenue. Its collections include more than 3.3 million works of art from ancient, medieval, and modern times and from all areas of the world. The collections are divided into nineteen curatorial departments. In each department, curators acquire, preserve, and exhibit works of art for both the permanent collections and special exhibitions.

The permanent collections offer a comprehensive survey of art from the ancient civilizations of Egypt, the Near East, Greece, and Rome to the present time. The Museum's holdings in European art are unparalleled outside Europe. In addition to one of the world's great collections of European paintings, the Metropolitan has outstanding collections of medieval art and architecture and of prints, photographs, drawings, costumes, musical instruments, sculpture, and decorative arts from the Renaissance through the twentieth century. The Museum's collection of American art, exhibited in the recently opened American Wing, is the most comprehensive in the world. Its collections of Far Eastern art are extensive, and its Islamic collection is the largest in existence. A new wing on the south side of the building houses an impressive collection of African and Oceanic art as well as that from Native North and South America. The Cloisters, a branch of the Metropolitan, is devoted to the arts of the Middle Ages. The building, which opened to the public in 1938, is within Fort Tryon Park, overlooking the Hudson River.

The educational function of the Museum is implicit in every facet of the Museum's endeavors. The Museum's bimonthly *Calendar/News* provides a handy index to the many ongoing programs and activities.

Museum Information

Admission: \$4.00 suggested for adults, \$2.00 suggested for students and senior citizens; free for members and children under twelve, accompanied by an adult. The tax-deductible admission fee is mandatory, but you may pay more or less than the suggested amount. Help us keep galleries open by contributing as generously as you can.

Museum Hours: Open Tuesday 10:00-8:45; Wednesday-Saturday 10:00-4:45; Sunday and holidays 11:00-4:45. Closed all Mondays and January 1, Thanksgiving Day, and December 25.

Visitors' Center: The Visitors' Center is located at the Information Desk in the Great Hall and is staffed by Museum volunteers. In addition to assisting in the registering of adult and high school groups, the volunteers provide information about the Museum and about exhibitions at other cultural institutions in New York.

Gallery Closings: Certain galleries may be closed for a portion of each day because of a shortage of guards. For current schedule, inquire at the Visitors' Center or at the Admission Desks.

Museum Restaurant: Open Tuesday-Friday from 10:00 for coffee, 11:00-3:00 for lunch; 3:00-4:30 for coffee and cocktails. Open Tuesday 5:00-8:15 for dinner. Open Saturday 11:30-4:15 and Sunday 12:00-4:15

Art, Book, and Gift Shops: Located off the Great Hall, these shops offer a large selection of books, children's publications, postcards, prints, posters, and reproductions of sculpture, jewelry, and other works from the Museum's collections.

Group Visits: All groups must make reservations in advance. Call 570-3711.

Recorded Tours: Recorded tours of the Museum's collection and special exhibitions are available for rent. Audioguide desks are located in the Great Hall and near special exhibitions.

Gallery Tours: Tours in English take place daily; tours in Spanish and French are held weekly. Inquire at the Visitors' Center for schedule, topics, and meeting places.

Wheelchairs: Available upon request at Coat Check areas. Exhibitions and galleries are accessible by wheelchair.

Handicapped Visitors: For activities for the sight-impaired, call 879-5500, ext. 3561. For access to the Telephone for the Deaf (TTY), call 879-0421.

Strollers: Permitted on weekdays only in all galleries except Egyptian and special exhibitions.

Photography/Sketching: Special permits are not required for sketching in permanent collections or for personal snapshots taken with handheld cameras during Museum hours. The use of flashbulbs or attachments is not allowed, nor is photography in special exhibitions. Inquire at the Visitors' Center regarding permission to sketch in special exhibitions.

Concerts and Lectures: For subscription concerts and lectures, call the Concerts and Lectures Office at 570-3949. Open for ticket sales Tuesday-Friday, 1:00 to 4:00 and Saturday and Sunday, 11:00 to 4:00. (Closed Saturday and Sunday from June through September.)

Education Programs: Consult *Calendar/News* at Visitors' Center for listings.

Libraries and Study Rooms: For information on the Thomas J. Watson Library, the Photograph and Slide Library, and the study rooms for prints, drawings, and textiles, call 879-5500.

Parking: The Parking Garage is open daily and is located at 80th Street and Fifth Avenue. There is a fee.

Coat Check Areas: Located at Museum entrances. All packages and umbrellas must be checked before entering the galleries.

First Aid: Ask nearest guard, who will call for medical aid.

Lost and Found: Inquire at the Visitors' Center.

The Cloisters: The Museum's branch for medieval art is located in Fort Tryon Park at the northern tip of Manhattan. Take the Madison Avenue bus no. 4, marked "The Cloisters-Fort Tryon Park," or take the Eighth Avenue Subway to 190th Street (Overlook Terrace station) and transfer to the no. 4 bus, or walk through the park. *Hours:* Open Tuesday-Saturday 10:00-4:45. Open Sunday and holidays 1:00-4:45; summer hours (from the first Sunday in May through the first Sunday in October) 12:00-4:45. Closed all Mondays and January 1, Thanksgiving Day, and December 25. *Telephone Information:* 923-3700.

Floor Plan

The Metropolitan Museum of Art

